

Installation Guide

Replacement SmoothControl+™ Pneumatic Damper

Adjustment Screw for Andersen® 1-1/2" Fullview Storm Doors



Please Do Not Return Product to Store!

PLEASE call the storm door Solution Center at 1-800-933-3626, with any questions regarding installation, lost part replacement, or anything else related to your storm door purchase.

Read this entire guide before you begin your installation. If your abilities do not match the requirements of this installation, contact an experienced contractor.

PARTS OVERVIEW

Your installation kit should contain the following parts.

- A** Pneumatic Damper Adjustment Screw

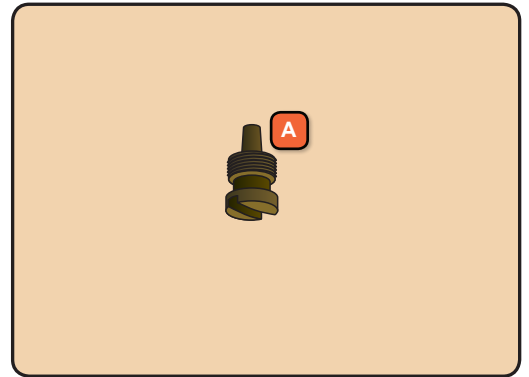

SAFETY FIRST: Please read and follow all Cautions and Warnings in this guide.

RECOMMENDED TOOLS



Safety Glasses

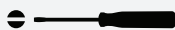

Straight head
Screwdriver



Work Gloves

WARNING

Storm doors have small parts. Small parts if swallowed could pose a choking hazard to young children. Dispose of unused, loose, or easily removed small parts. Failure to do so could result in injury.

CAUTION

Some components may contain sharp edges. Wear appropriate protective equipment to avoid potential injury.



This is the Safety Alert Symbol used to alert you to potential injury hazards. Obey all safety messages that follow this symbol to avoid possible injury or death.

Signal Word and Consequence

COULD

Result in:

 **WARNING**
Major Injury / Death

COULD

Result in:

 **CAUTION**
Minor Injury

COULD

Result in:

NOTICE
Product or Property
Damage

IMPORTANT
Procedure and Product
Information

1

REMOVE PNEUMATIC DAMPER ADJUSTMENT SCREW AND INSTALL REPLACEMENT PART

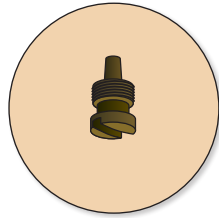

Tools recommended:

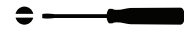

Straight head
Screwdriver

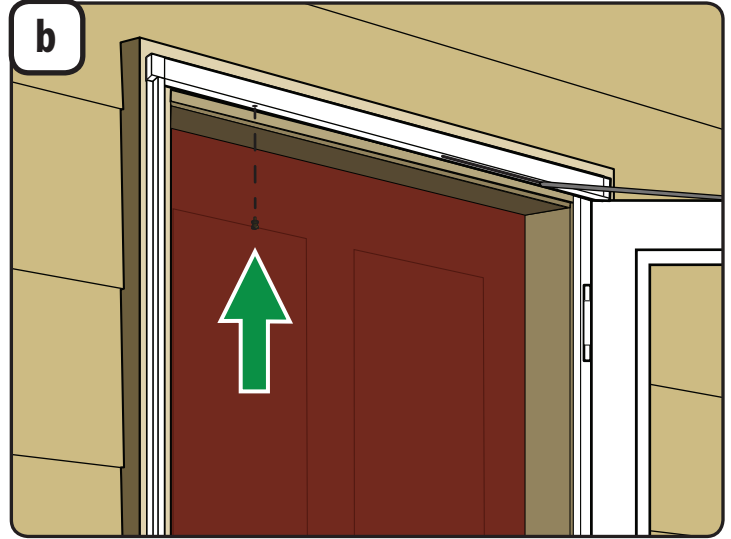
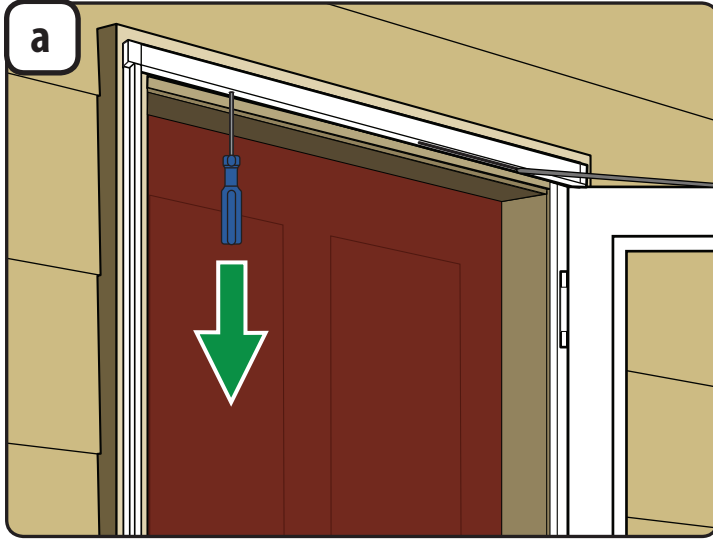

1. Open the door and with straight head screwdriver remove old pneumatic damper adjustment screw and dispose of properly.

1. Install the new damper adjustment screw.

IMPORTANT

Take special care to ensure the threads are aligned correctly before installing the new adjustment screw.

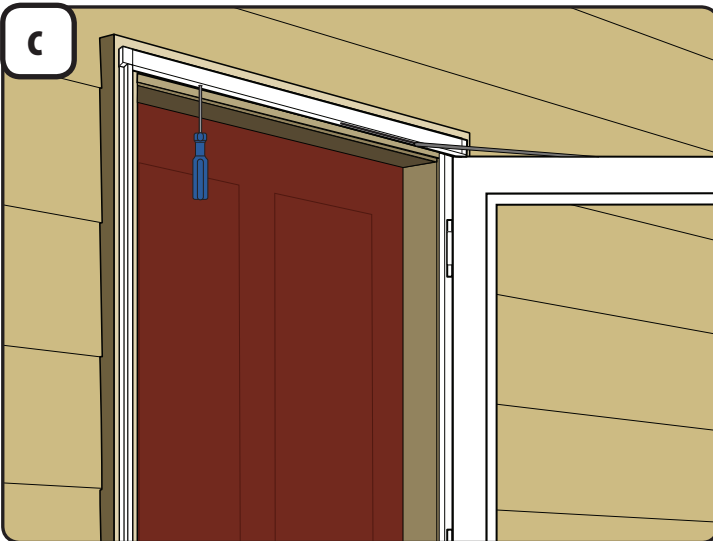

1. Open the door and then let it close. Note the speed at which the door closes.
2. Use a flat blade screwdriver to adjust the closer to the desired speed: For a faster closing speed, turn the adjustment screw to the left (counterclockwise). For a slower closing speed, turn the adjustment screw to the right (clockwise).
3. Test the speed at which the door closes after each adjustment. Adjust the screw more, if needed, to achieve the desired door closing speed.

WARNING

Storm door will close more quickly when the entry door is open. To achieve the proper closing speed, you will need to adjust the closer using the built-in adjustment screw. Check for safe closing speed with your entry door in both the closed and open position. To prevent injury, make sure people and/or pets are completely through the opening before allowing the storm door to close freely.

CAUTION

Hidden closer is under tension and has several areas that can pinch as it closes the door. Use caution when working around the hidden closer components.