

Installation Guide

Replacement Passive Handle for Andersen® LuminAire® Retractable Insect Screen Double Door

For installation help please visit www.AndersenLuminAire.com/install



Please Do Not Return Product to Store!

PLEASE call the Storm Door Solution Center at 844-813-6664, with any questions regarding installation, lost part replacement, or anything else related to your retractable insect screen purchase. Replacement parts can also be found at: parts.andersenstormdoors.com

Read this entire guide before you begin your installation. If your abilities do not match the requirements of this installation, contact an experienced contractor.

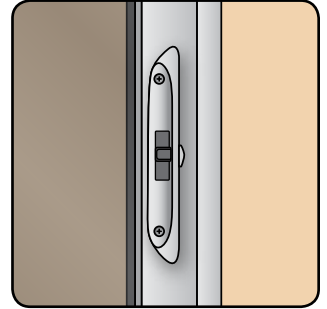

PARTS OVERVIEW

Your replacement part should contain the following parts.

- 1** Interior Handle
- 2** Exterior Handle
- 3** Handle Screws

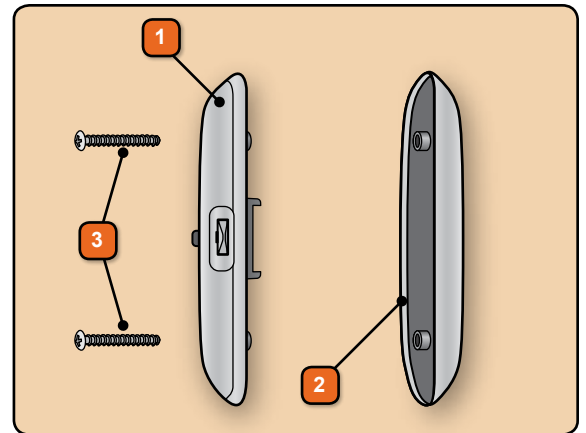

SAFETY FIRST: Please read and follow all Cautions and Warnings in this guide.

RECOMMENDED TOOLS



Safety Glasses

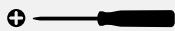

Screwdrivers

WARNING

Follow manufacturers' instructions for hand and power tools. Always wear safety glasses. Failure to do so could result in injury, product or property damage.

CAUTION

Metal components of the retractable insect screen may become hot when exposed to sunlight.

IMPORTANT

The retractable insect screen is intended for reasonable insect control and not the retention of objects, persons, or pets within the interior. The retractable insect screen will not stop a person from falling through the door.



This is the Safety Alert Symbol used to alert you to potential injury hazards. Obey all safety messages that follow this symbol to avoid possible injury or death.

Signal Word and Consequence

COULD Result in:	WARNING Major Injury / Death	COULD Result in:	CAUTION Minor Injury
COULD Result in:	NOTICE Product or Property Damage	IMPORTANT Procedure and Product Information	

HANDLE REMOVAL & REINSTALLATION

Tools Recommended:

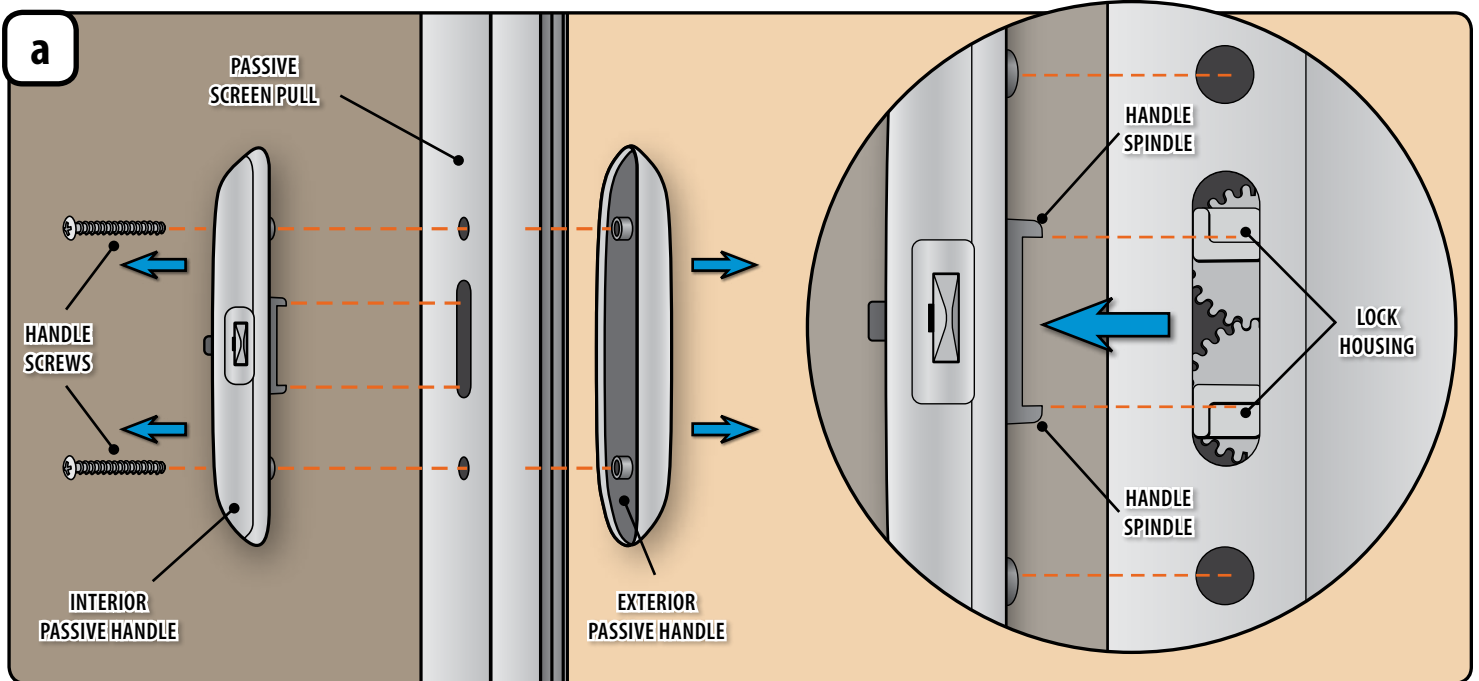
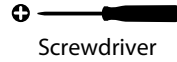

- a** From the interior side of the Passive Screen Housing, remove the two Handle Screws with a Phillips screwdriver. Carefully pulling the handles from the Passive Screen Pull.

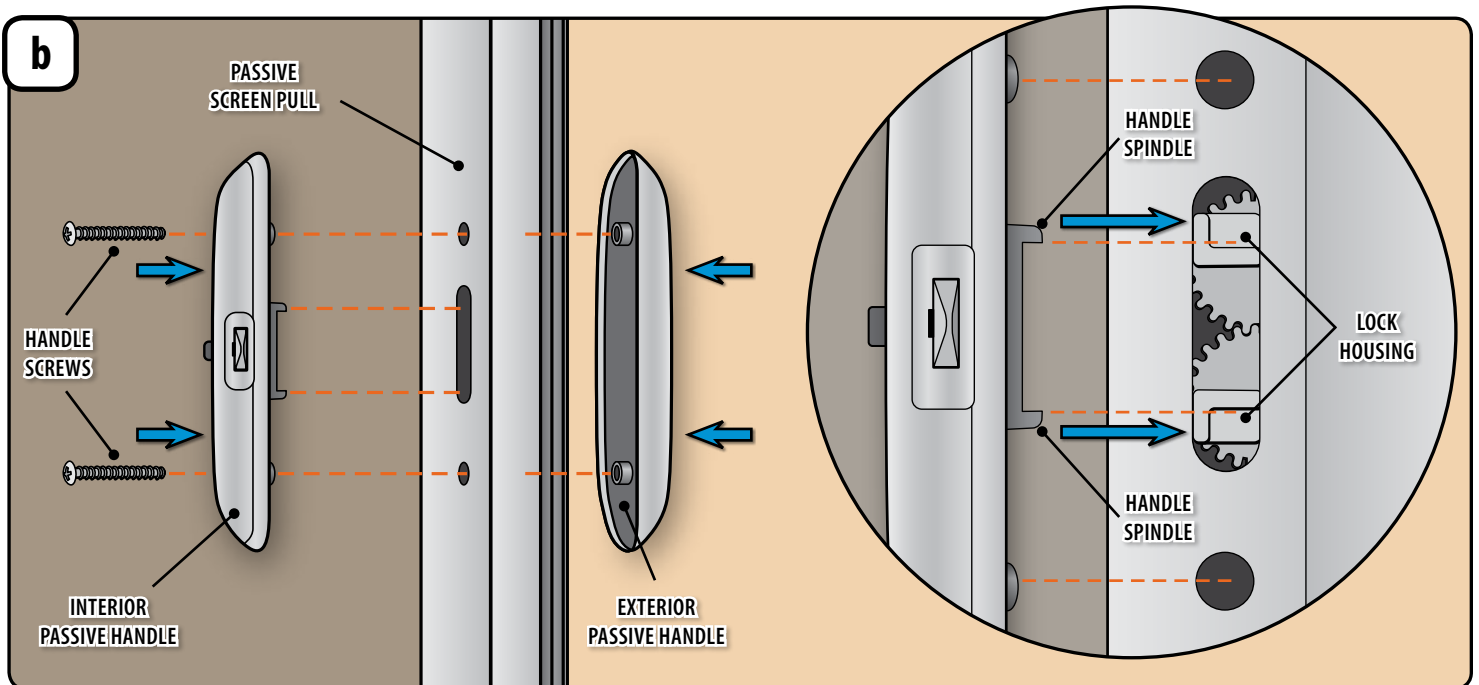

- b1** Place the Exterior Passive Handle on the exterior side of the Passive Screen Pull.
- b2** Place the Interior Passive Handle onto the interior side of the Passive Screen Pull, aligning the Handle Spindles with the Lock Housing as you slide them together.
- b3** Install the two Handle Screws in the Interior Passive Handle.