

Replacement Guide

for Hinge Rail on 1-1/2" Andersen® Doors



Please Do Not Return Product to Store!

PLEASE call the storm door Solution Center at 1-800-933-3626, with any questions regarding installation, lost part replacement, or anything else related to your storm door purchase.

Read this entire guide before you begin your installation. If your abilities do not match the requirements of this installation, contact an experienced contractor.

PARTS OVERVIEW

Your installation kit should contain the following parts. However, in some door models, not all of the parts will be used.

- A** Hinge Rail
- B** Screw Cover
- C** Screw Pack (note shown)
- D** Hinge Screw / Spacer Pack
(Pink bag, not shown)

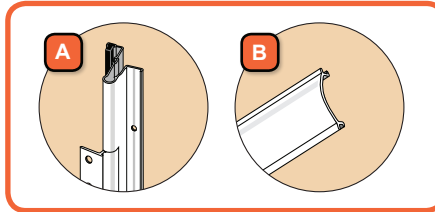

SAFETY FIRST: Please read and follow all cautions and warnings in this guide.

WARNING

Metal fasteners and other hardware components may corrode when exposed to preservative treated and fire-retardant treated lumber. Obtain and use the appropriate size stainless steel fasteners and hardware as called out by the installation guide to fasten unit to any rough opening made from pressure treated and fire-retardant treated lumber. Failure to use the appropriate materials for the installation may cause a failure resulting in injury, property or product damage.

WARNING

Entry door hardware and handle may become hot when exposed to sunlight.

WARNING

Windows and doors can be heavy. Use safe lifting techniques and a reasonable number of people with enough strength to lift, carry, and install window and door products to avoid injury and/or property damage.

WARNING

Improper use of hand or power tools could result in injury and/or product damage. Follow equipment manufacturer's instructions for safe operation. Always wear safety glasses.

RECOMMENDED TOOLS

Gloves



Pencil



Drill



Tape Measure



Scissors



Step Ladder



Safety Glasses



1/8"



Screwdriver

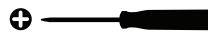

Saw



ALL IMAGES SHOW A LEFT HAND INSTALLATION.

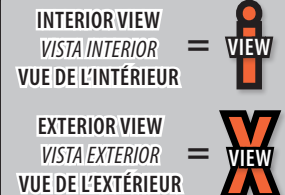

1

REMOVE HINGE RAIL (Left Hand)

Tools needed:

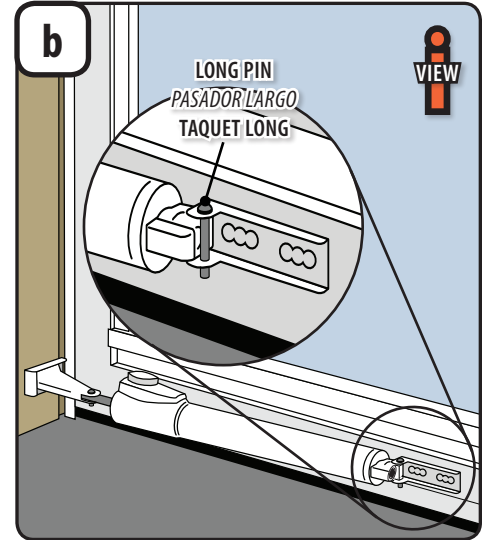
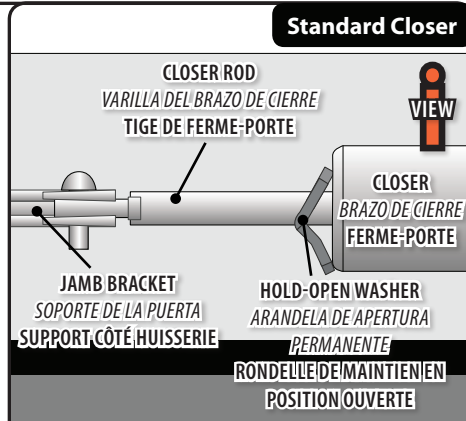
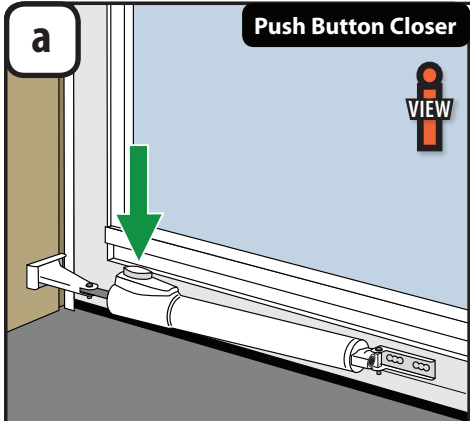
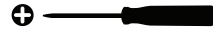

IMPORTANT

Closer styles and quantities may vary. All closers must be separated from storm door.

1. Open door a few inches.
2. For Push Button Closers: Push down button on closer.
For closers with hold open washers: Move hold open washer against closer.
For closers without hold open washers: Hold onto closer.

1. Remove long pin(s) connecting closer to door bracket and set aside, to be re-installed later.
2. Swing closer(s) away from door.

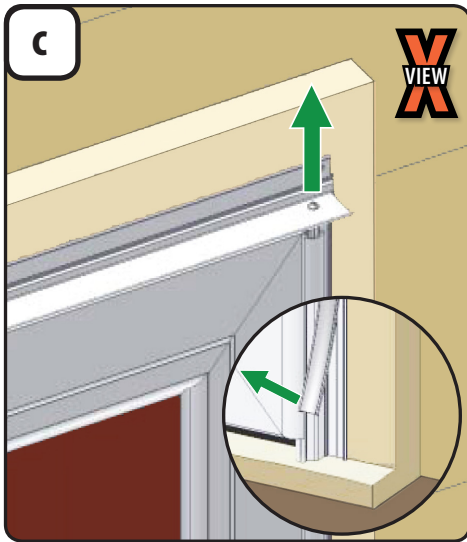

1. Remove one plug from rain cap, if applicable.
2. Remove screw cover by prying up the edge with a screwdriver, and peeling the screw cover out of the track.
3. Properly dispose of screw cover.

REMOVE DOOR (Left Hand)

2

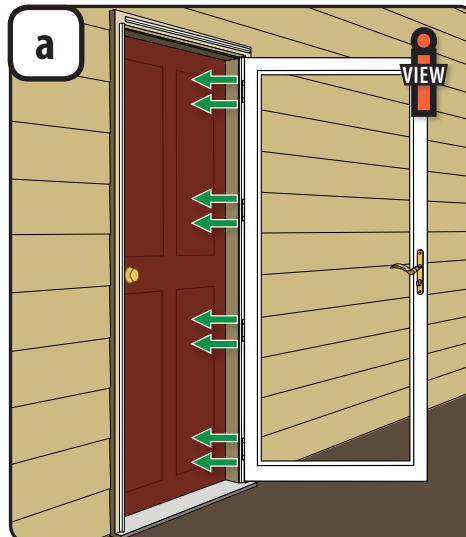

1. Open door and remove eight 1" screws from inside of hinge rail.

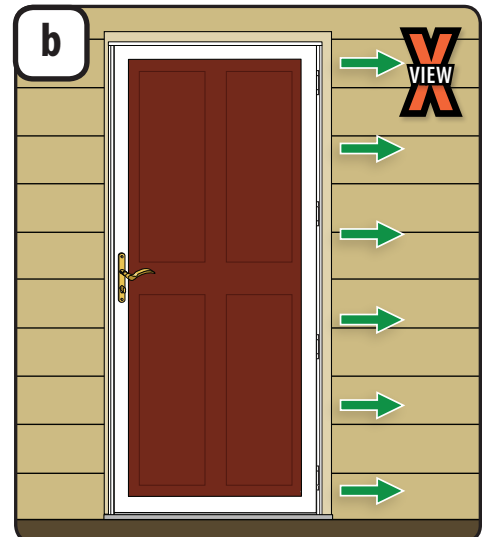

1. Remove six 1" screws from latch rail.
2. Remove hinge rail and door.

3 REMOVE HINGE RAIL (Left Hand)

Tools needed: 



4 ATTACH NEW HINGE RAIL TO DOOR (Left Hand)

Tools needed:  

PINK BAG // BOLSA ROSA // SAC ROSE

D 1/2"  x 8

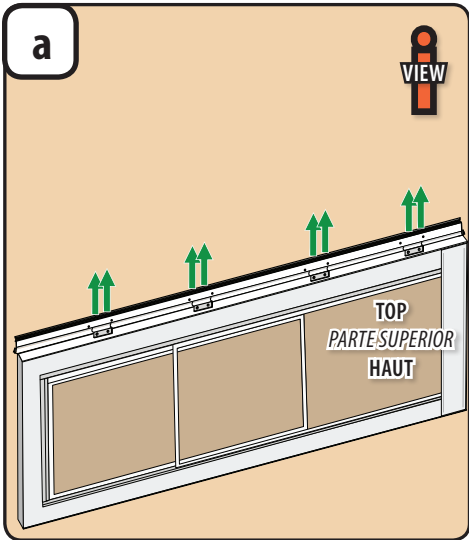

1. Remove eight screws from hinge rail and remove hinge rail from door frame.
2. Properly dispose of screws.

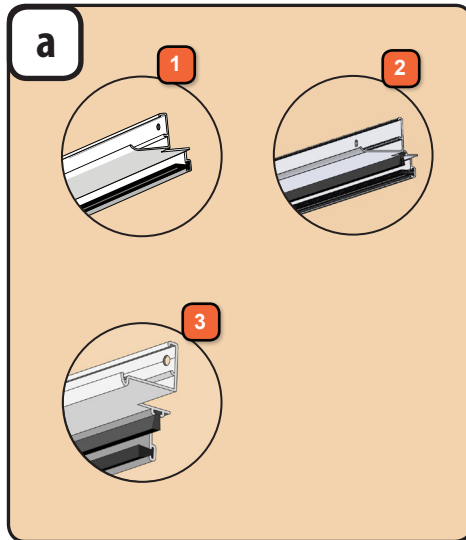

1. Identify rain cap profile for hinge rail replacement on door frame in **step b**.
2. If rain cap profile matches option 1 or 2 above, place hinge rail 1/8" above door frame. If rain cap profile matches option 3 above, place hinge rail 1/4" above door frame.

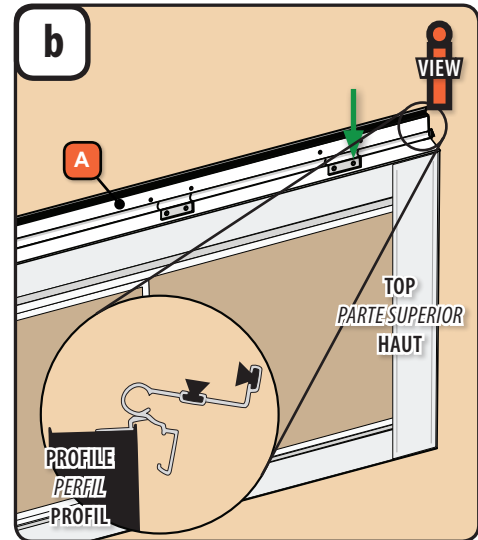

1. Identify the top of the hinge rail (A).
2. Position the hinge rail along the hinge-side edge of the door frame so the top of the hinge rail extends beyond the top of the door frame using measurements from **step a**.
3. Attach all four hinge leaves to the door frame using unpainted 1/2" screws from the pink bag.

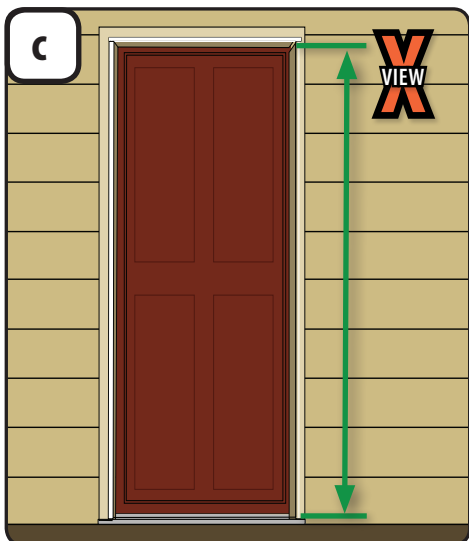

1. Measure the height of the door opening, measuring from the underside of the rain cap to the door sill.
2. You will use this measurement to cut the latch rail to its proper length.

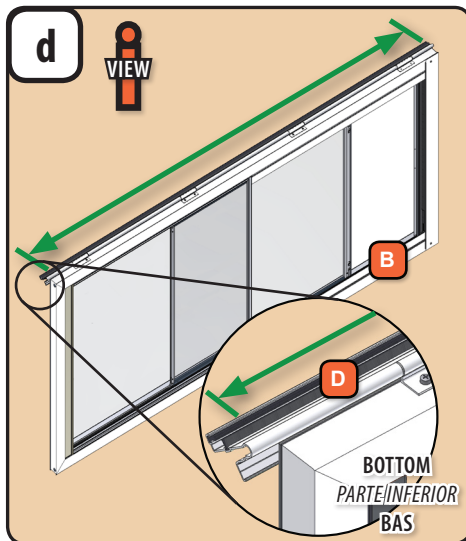

1. Measure the hinge rail, starting at the top and then marking the bottom with the measurement from **step c**.
2. Using a hacksaw, cut the hinge rail to length.

5

INSTALL HINGED STORM DOOR IN OPENING (Left Hand)

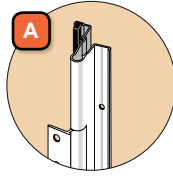

Tools needed:

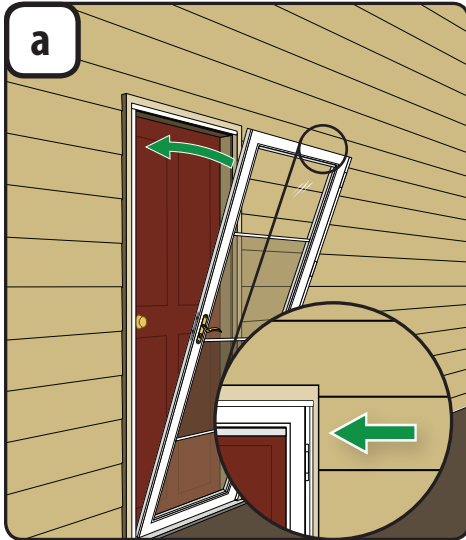
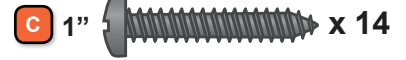
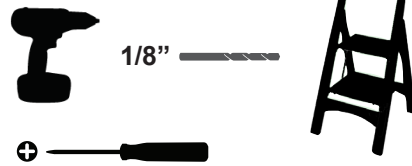

1. Set the door frame on the entry sill so the hinge rail is tight against the mounting surface or hinge rail shim, if applicable.
2. The top of the hinge rail should be flush against the underside of the rain cap and even with its end.

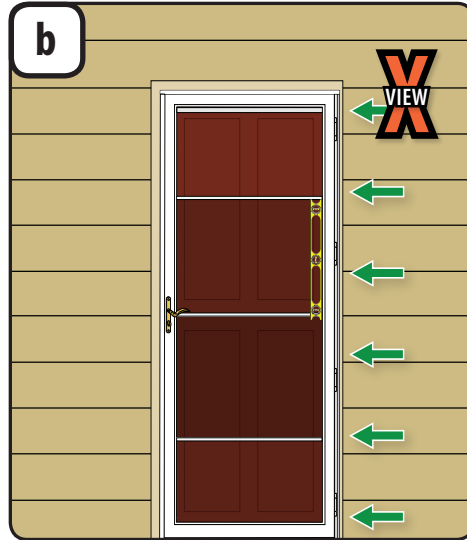

1. The top hole of the hinge rail should align with the top hole in the mounting surface. Note: If any of the hinge rail holes and mounting surface holes do not line up, you will need to pre-drill holes using an 1/8" drill bit. Install one #8 x 1" screw into this hole.
2. Using the level, make sure that the door is plumb. While holding door in position, fasten the hinge rail to the mounting surface through the remaining hinge rail holes, using the #8 x 1" screws.

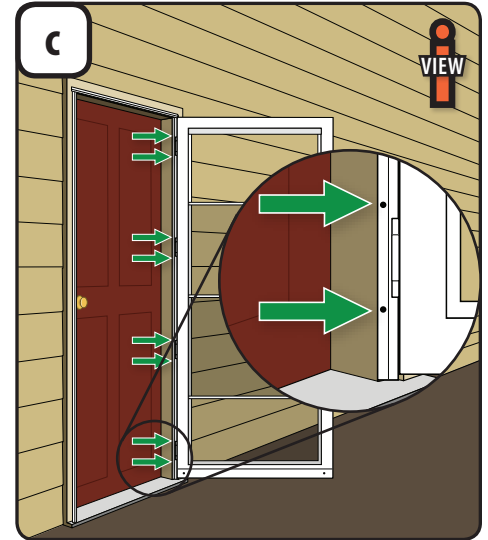

1. Open the storm door.
2. If any of the hinge rail holes and mounting surface holes do not line up, you will need to pre-drill holes using an 1/8" drill bit.
3. Fasten the hinge rail to the door jamb using 1" screws from the yellow bag.

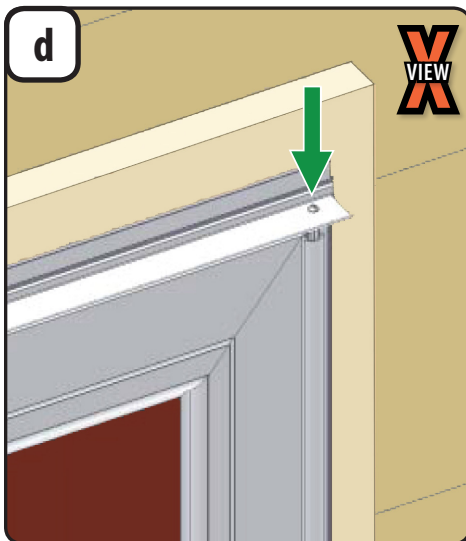

1. Locate the hole on the end of the curved leg of the rain cap.
2. Install the plug from the pink bag, into this hole from the top.

6

RE-ATTACH CLOSER(S) TO DOOR AND RE-INSTALL SCREW COVER (Left Hand)

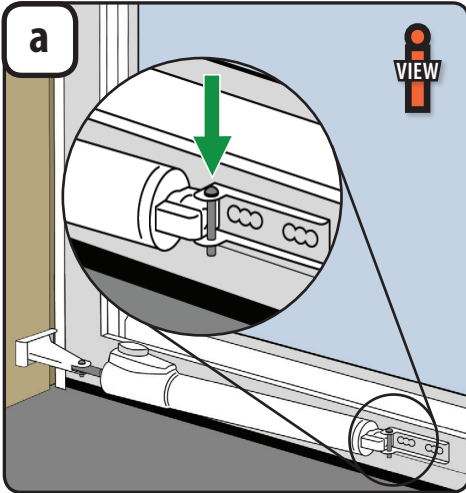
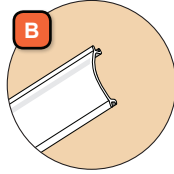

1. Door bracket(s) should still be on the door.
2. Join closer cylinder(s) with jamb bracket(s) and secure with long pin removed previously.

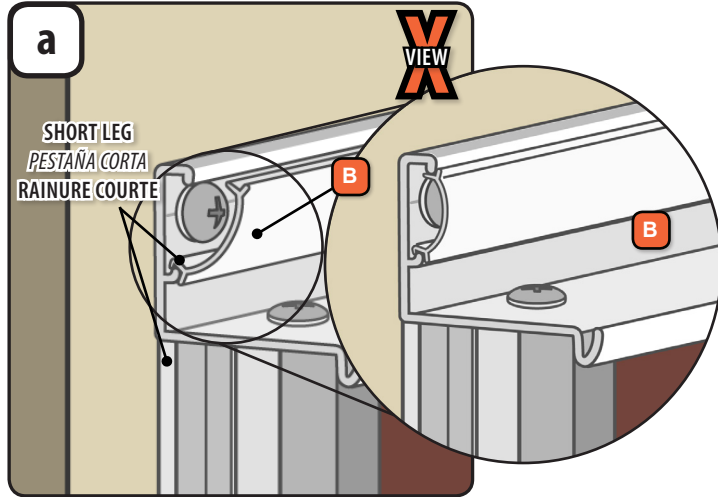

1. Lock leg of screw cover (B) into short leg of latch rail screw track (**installing the screw cover into the rain cap is shown for clarity**). Press on other leg to snap it into long leg of track. Make sure screw cover snaps into screw track along the entire length of the rain cap.
2. Using scissors, trim off any excess that may remain.

7

ADJUST CLOSING SPEED OF DOOR

Closer and door shown are for reference only.

Tools needed:



! WARNING

Storm door will close more quickly when entry door is open. To achieve the proper closing speed, you will need to adjust the closer(s) using the built-in adjustment screw. Check for safe closing speed with your entry door in both the closed and the open position. To prevent injury, make sure people and/or pets are completely through the opening before allowing the storm door to shut freely.

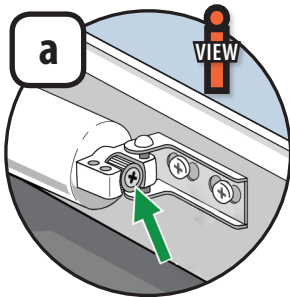

1. Open the door and then let it close. Note the speed at which the door closes.
2. Using a Phillips head screwdriver to adjust the closer to the desired speed:
For a faster closing speed, turn the adjustment screw to the left (counterclockwise).
For a slower closing speed, turn the adjustment screw to the right (clockwise).
3. Test the speed at which the door closes after each adjustment. Adjust the screw more, if needed, to achieve the desired door closing speed.