

Replacement Guide

for Rain Cap and Rain Cap with Extender on Andersen® and EMCO® Doors



Please Do Not Return Product to Store!

PLEASE call the storm door Solution Center at 1-800-933-3626, with any questions regarding installation, lost part replacement, or anything else related to your storm door purchase.

Read this entire guide before you begin your installation. If your abilities do not match the requirements of this installation, contact an experienced contractor.

PARTS OVERVIEW

Your installation kit should contain the following parts.

- A** Rain Cap
- B** Rain Cap Extender
- C** Screw Cover
- D** Screw Pack (not shown)

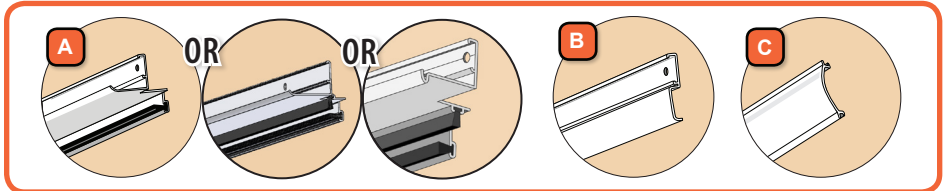

SAFETY FIRST: Please read and follow all cautions and warnings in this guide.

WARNING

Metal fasteners and other hardware components may corrode when exposed to preservative treated and fire-retardant treated lumber. Obtain and use the appropriate size stainless steel fasteners and hardware as called out by the installation guide to fasten unit to any rough opening made from pressure treated and fire-retardant treated lumber. Failure to use the appropriate materials for the installation may cause a failure resulting in injury, property or product damage.

WARNING

Improper use of hand or power tools could result in injury and/or product damage. Follow equipment manufacturer's instructions for safe operation. Always wear safety glasses.

RECOMMENDED TOOLS



Drill

Safety Glasses



Gloves



Screwdriver

1/8"

Step Ladder



ALL IMAGES SHOW A LEFT HAND INSTALLATION.

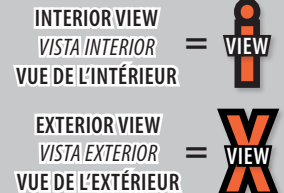

1

REMOVE RAIN CAP AND MOUNTING FLANGE & EXTENDER (If applicable)

Tools needed:

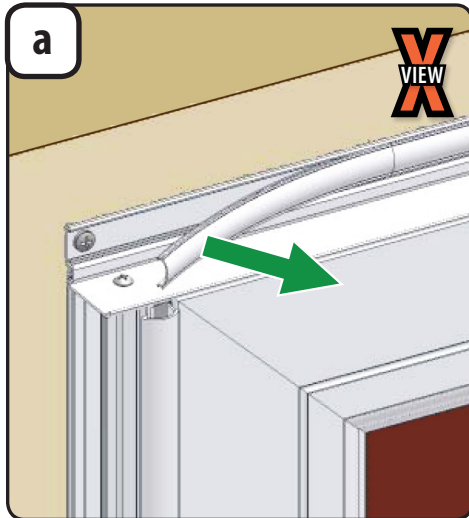

1. Remove screw cover by prying up the edge with a screwdriver, then peeling the screw cover out of the track.
2. Properly dispose of screw cover.

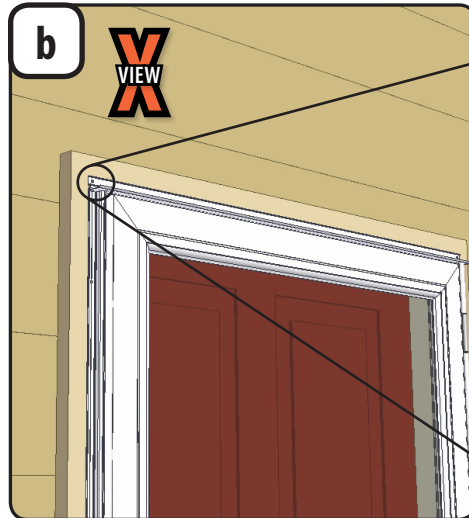

In this step, you will remove all of the fasteners which are holding the rain cap onto the mounting surface. Some rain caps have fasteners attached to the latch and hinge rail; these will be removed in **step c**.

1. Remove the 1" screws that were behind the screw cover.
2. If your door has a mounting flange, push down on it to unlock it from the rain cap, then pull away from the rain cap to remove it.
3. If your door has a rain cap extender, you will need to remove the extra 1" screws holding the rain cap to the mounting surface.
4. Retain all screws for future use.

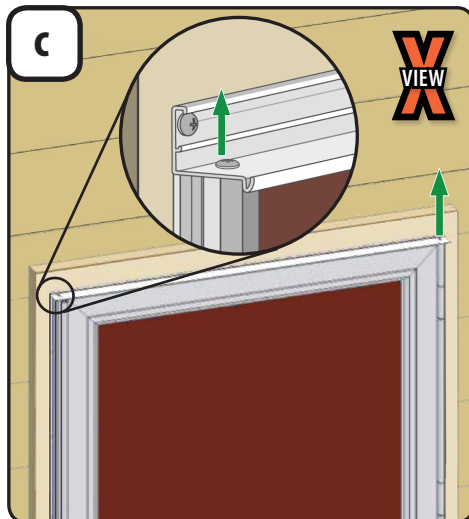

In this step, you will remove the fasteners which attach the rain cap to the latch and hinge rail, if applicable.

1. Remove the two 1/2" screws or two plugs holding the rain cap to the latch rail and hinge rail.
2. Retain all screws and plugs for future use.

2

INSTALL NEW RAIN CAP & EXTENDER (If applicable)

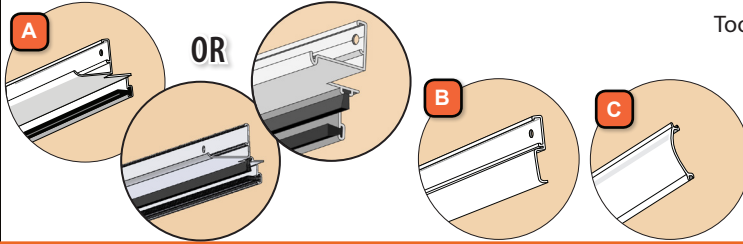

- Tools needed:
- 1/8" Drill Bit
 - 1" Screw x 3
 - 3/16" Plug x 1
 - Phillips Screwdriver

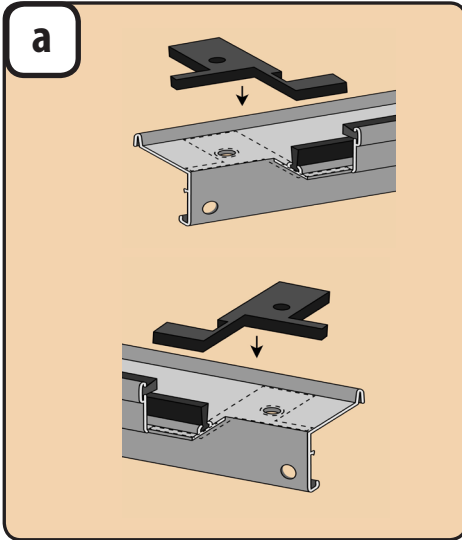

1. Place the new rain cap on top of the mounting rails and measure the gap between the door frame and rain cap. If the gap is less than 1/8" (i.e. the door will not open without hitting the rain cap), install the spacers as shown in the image above. If the gap is greater or equal to 1/8", skip this step and proceed to **step 2b**.

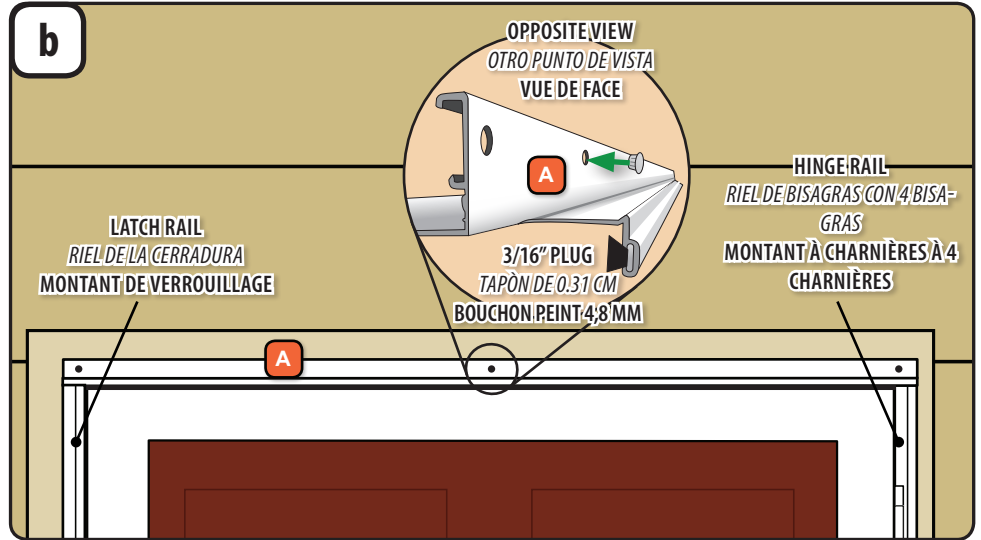

1. Open the storm door. Place the rain cap (A) in the opening so that it rests on top of the latch and hinge rail, aligning the end of the the rain cap with the edge of the hinge rail.
2. Look at the center hole of the rain cap. If the mounting surface can be seen in the entire hole, proceed to **step b**. If the mounting surface cannot be seen in the entire hole, or if there is space above the rain cap, then remove the rain cap.
3. From the mounting surface (back) side of the rain cap, completely insert a 3/16" plug into the middle hole.
4. Re-install the rain cap as described above.

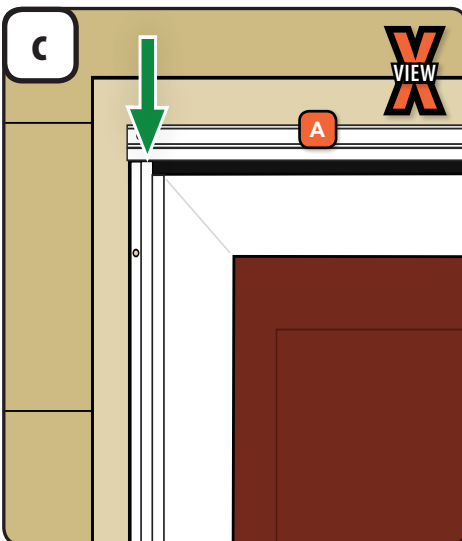

1. Locate the hole on each end of the top surface of the rain cap (A).
2. Install either the 2 screws or 2 plugs removed in **step 1c**, into these holes, from the top.

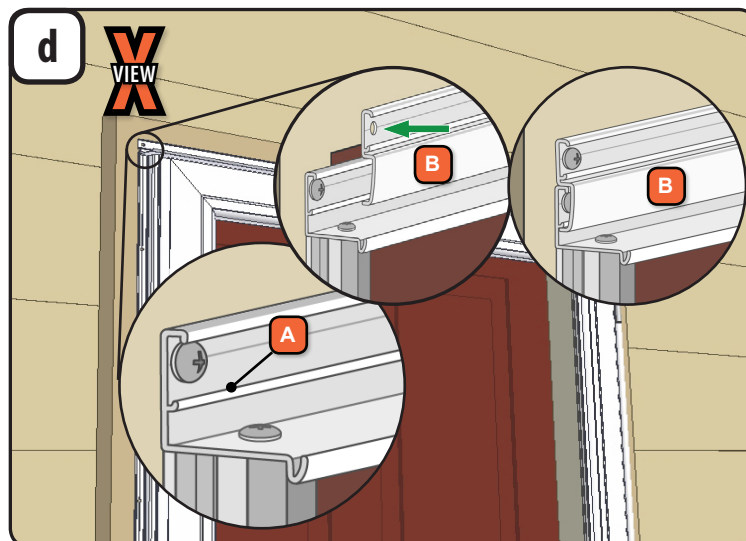

1. Using the drill bit and 1" screws removed previously, fasten the rain cap (A) to the mounting surface.
2. If a plug was installed in the middle hole, you will need to install the rain cap extender (B).
3. Place the rain cap extender over the rain cap as shown, with both ends being flush.
4. Using the drill bit and 1" screws removed previously, fasten the rain cap extender to the mounting surface.

3

INSTALL SCREW COVERS

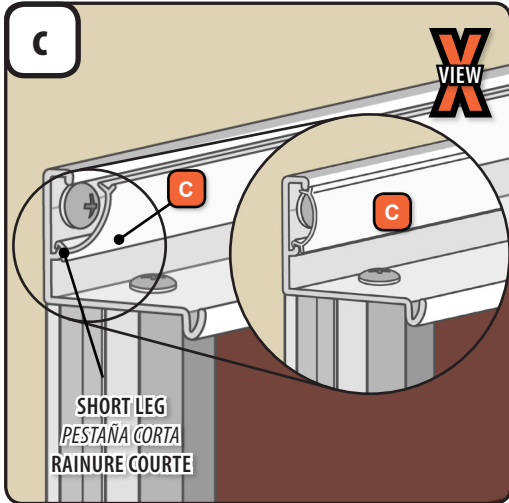
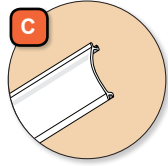

1. Lock leg of screw cover (C) into short leg of rain cap screw track. Press on other leg to snap it into long leg of track. Make sure screw cover snaps into screw track along the entire length of the rain cap.