

Pro Installation Guide

This installation guide is only for ProInstall Double Door Astragal Kits for Andersen® ProInstall Doors. For all other doors, use the standard Installation guide provided.



Please Do Not Return Product to Store!

PLEASE call the storm door Solution Center at

1-800-933-3626,

with any questions regarding installation, lost part replacement, or anything else related to your storm door purchase.

Read this entire guide before you begin your installation. If your abilities do not match the requirements of this installation, contact an experienced contractor.

PARTS OVERVIEW

Your installation kit should contain the following parts. However, in some door models, not all of the parts will be used.

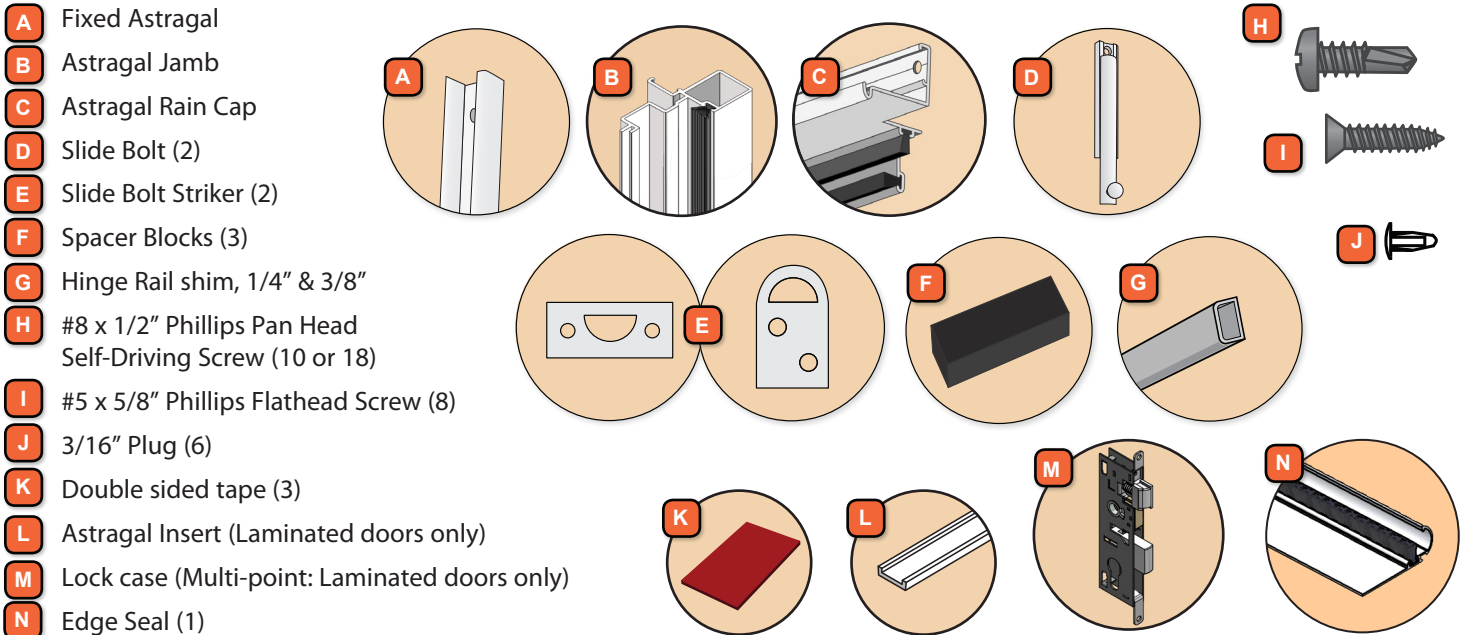

SAFETY FIRST: Please read and follow all Cautions and Warnings in this guide.

WARNING

Entry door hardware and handle may become hot when exposed to sunlight.

WARNING

Improper use of hand or power tools could result in injury and/or product damage. Follow equipment manufacturer's instructions for safe operation. Always wear safety glasses.

WARNING

Metal fasteners and other hardware components may corrode when exposed to preservative treated and fire-retardant treated lumber. Obtain and use the appropriate size stainless steel fasteners and hardware as called out by the installation guide to fasten unit to any rough opening made from pressure treated and fire-retardant treated lumber. Failure to use the appropriate materials for the installation may cause a failure resulting in injury, property or product damage.

WARNING

Windows and doors can be heavy. Use safe lifting techniques and a reasonable number of people with enough strength to lift, carry, and install window and door products to avoid injury and/or property damage.

WARNING

The insect screen is intended for reasonable insect control and not the retention of objects or persons within the interior. The insect screen material will not stop a person from falling through the door.

RECOMMENDED TOOLS

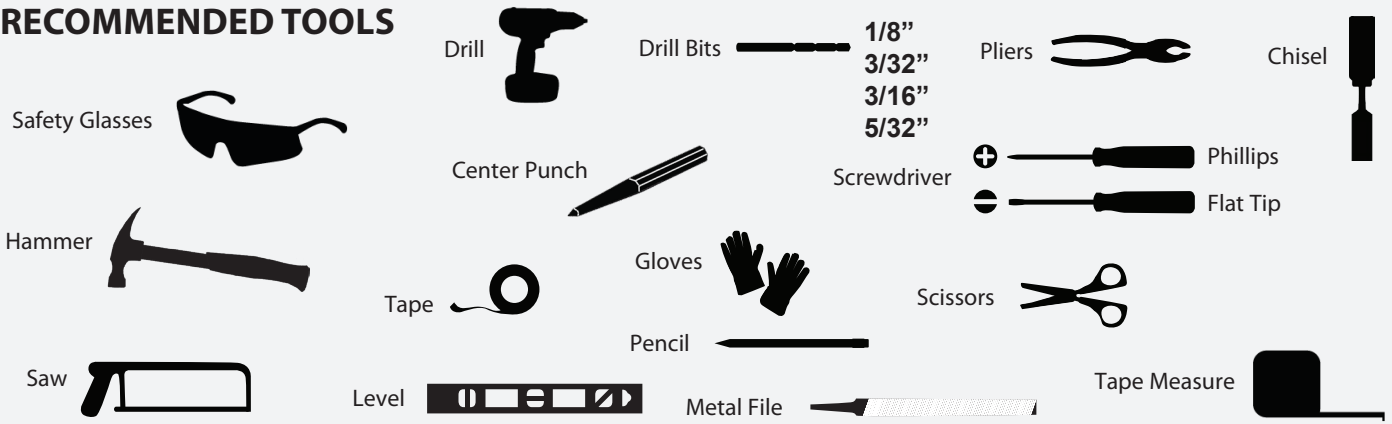

1 VERIFY MOUNTING REQUIREMENTS

Verify that the exterior brick mold, trim board or casing is firmly attached to the opening. The storm door will sag over time if the mounting surface is not sufficiently fastened to the entryway.

To install the storm door, you must verify that the opening width, height and mounting surface are sufficient.

1. Measure the width at the top, middle, and bottom of the opening (Figure 2). Measure from the inside of the brick mold or exterior trim. Refer to Table 1.
2. Measure the height at the center of both doors. Measure from the inside of the brick mold or exterior trim, down to the top of the bottom sill. Refer to Table 1.

Table 1:
Use this table to determine if your storm door will fit into the opening:

Nominal Storm Door Sizes **	Opening Sizes	
	W 1 - 3 (width) *	H (height)
Two 30" x 80" Doors	59 3/4" TO 60 3/8"	80" TO 81"
Two 32" x 80" Doors	63 3/4" TO 64 3/8"	
Two 33" x 80" Doors	65 3/4" TO 66 3/8"	
Two 34" x 80" Doors	67 3/4" TO 68 3/8"	
Two 36" x 80" Doors	71 3/4" TO 72 3/8"	78" TO 79"
Two 32" x 84" Doors	63 3/4" TO 64 3/8"	
Two 36" x 84" Doors	71 3/4" TO 72 3/8"	
Two Standard Custom Doors	59 3/4" TO 72 3/8"	72" TO 84 7/8"
Two XL Custom Doors	59 3/4" TO 84"	72" TO 96"

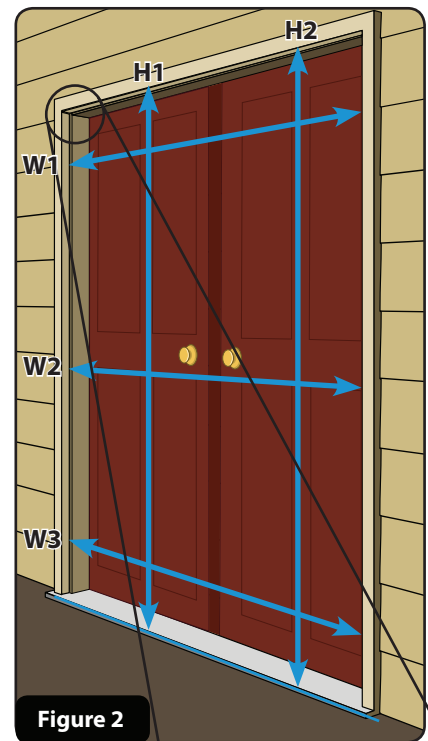

Figure 2

3. Make sure that the brick mold or exterior trim meets the mounting surface requirements to install the rain cap, hinge rail and latch rail (Figure 3). You must have a minimum of:

- 1" mounting surface depth. *
- 3/4" mounting surface front. *
- 2 1/2" handle clearance

* For opening widths up to 1" wider, please call our Solution Center at 1-800-933-3626 to purchase a special kit to accommodate your situation.

** Nominal storm doors sizes are listed. The actual storm door frame width and height will be less. Example: A nominal size of 36" x 80" may have an actual storm door frame size of 35 1/8" x 79 1/8".

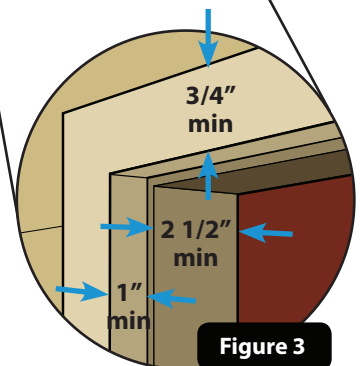
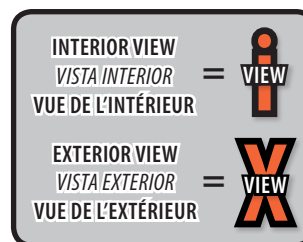

Figure 3

2

INSTALLATION PREPARATION

Tools needed:

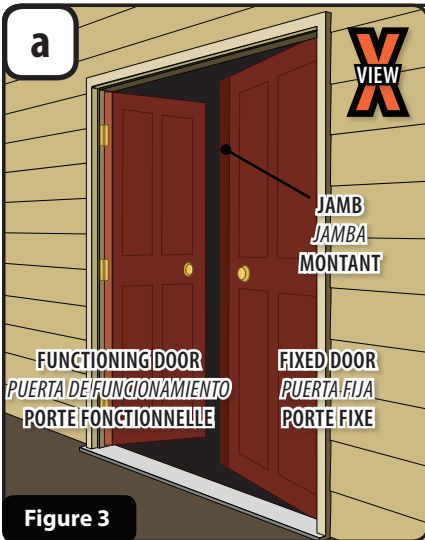
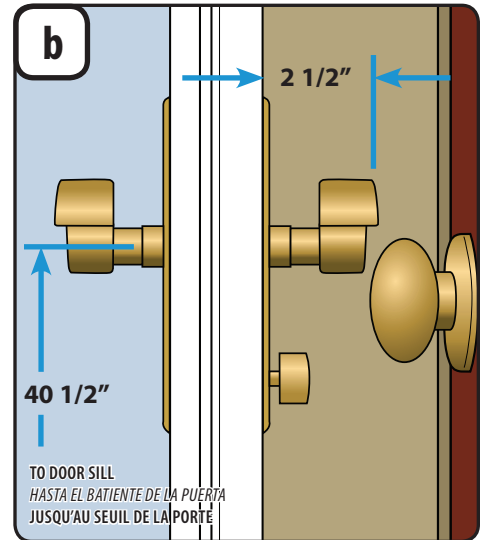

Figure 3



Figure 4



TO DOOR SILL
HASTA EL BATIENTE DE LA PUERTA
JUSQU'AU SEUIL DE LA PORTE

1. As shown in **Figure 3**, the fixed door has an attached jamb that the functioning door latches into.
2. The astragal kit has been designed for either a left or right functioning door (**Figure 4**). Determine which door you want fixed and which door you want functioning.
3. Position the door in the door opening to match your fixed door preference. Mark the top of the door with tape for reference. Be sure decorative side faces outward and handle mounting holes are to the center of the opening.
4. This guide will illustrate a right handed functioning door and a left handed fixed door (so functioning door is on the left of the opening). Remember to reverse directions if you are installing a left handed functioning door (where your functioning door is on the right).

1. While the door is in the opening, hold inside handle (from handle set parts box) in place to make sure it won't interfere with handles of your entry doors. If handles interfere, it may be necessary to consult with a professional carpenter to rework your door opening.

3

DETERMINE IF HINGE RAIL SHIM IS NEEDED

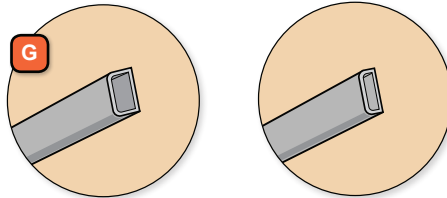

Tools needed:

Tape x 3

DOOR SIZE	No Shim Width Range	1/4" Shim Width Range	3/8" Shim Width Range
Two 30" Doors	59 3/4" TO 59 7/8"	59 15/16" TO 60 1/8"	60 3/16" TO 60 3/8"
Two 32" Doors	63 3/4" TO 63 7/8"	63 15/16" TO 64 1/8"	64 3/16" TO 64 3/8"
Two 33" Doors	65 3/4" TO 65 7/8"	65 15/16" TO 66 1/8"	66 3/16" TO 66 3/8"
Two 34" Doors	67 3/4" TO 67 7/8"	67 15/16" TO 68 1/8"	68 3/16" TO 68 3/8"
Two 36" Doors	71 3/4" TO 71 7/8"	71 15/16" TO 72 1/8"	72 3/16" TO 72 3/8"

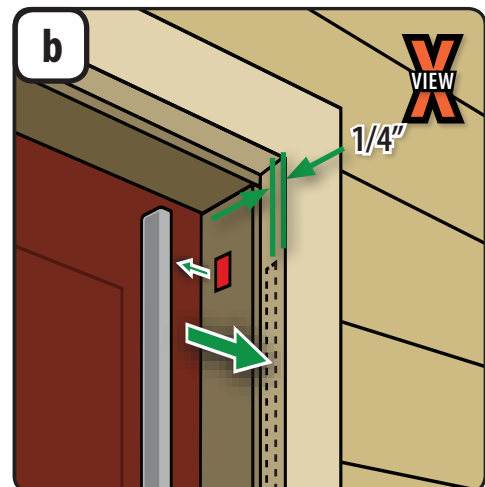

1. Use the table above to determine which shimming method to use, if applicable. The shims (G) are located in the astragal kit.
2. If your doors do not require a shim, proceed to **step 4**.

1. Remove any debris from the mounting surface where the hinge rail shim will be attached on the fixed door side.
2. Apply the three strips of double stick tape to the shim, spacing them evenly along the entire length. Attach the shim to the mounting surface on the fixed door side, as shown.

4 REMOVE GLASS PANEL FOR DOORS WITH A SHIPPING CLIP AS SHOWN BELOW

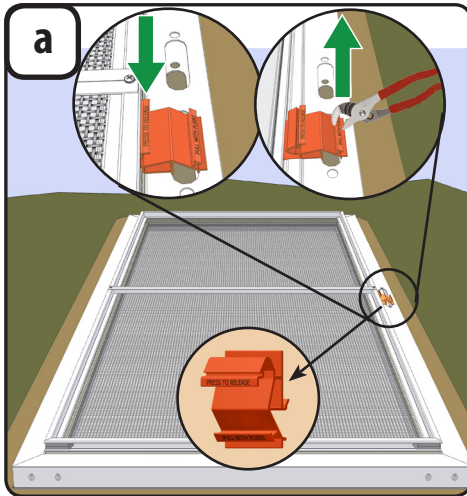

1. Lay the door flat on a protected surface with the exterior side down.
TIP: Lay on door carton.
2. Remove insect screen by pressing down on the shipping clip to release insect screen.
3. Remove the shipping clip using a pair of pliers. Grasp shipping clip and pull out of door frame. Properly dispose of shipping clip.

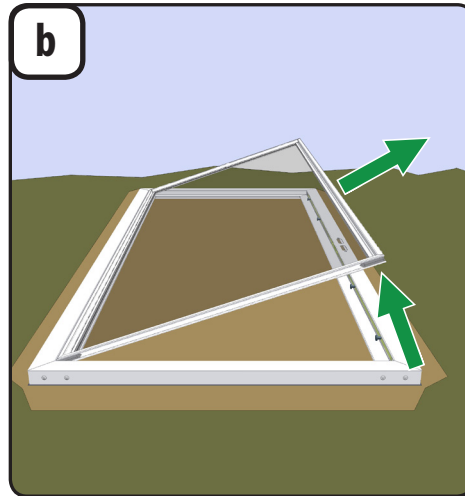

1. To remove the glass panel, first reach under the side of the door frame near the handle holes and gently push up on glass panel until you are able to firmly grasp onto it.
2. While maintaining a firm grip on glass panel, gently lay door frame back down. Pull glass panel away from opposite side of door frame and then lift it out of door frame and set aside.
3. Stand glass panel on its edge to prevent damage.

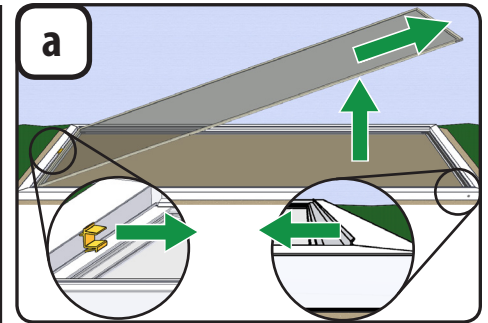

1. Lay the door flat on a protected surface with the exterior side down.
TIP: Lay on door carton.
2. Remove the insect screen by lifting it up and then away from the shipping clip.
3. Remove and properly discard the shipping clip.
4. Using your fingers, grasp the exposed retainer lip.
TIP: To prevent kinks and damage to the side retainers, do not pull straight up on them.
5. Pull the side retainer towards the center of the door frame, working along the entire length of the side retainer.
6. Remove the glass panel and set aside. Stand the glass panel on its edge to prevent damage to it.

5

PREPARE FIXED STORM DOOR FOR INSTALLATION

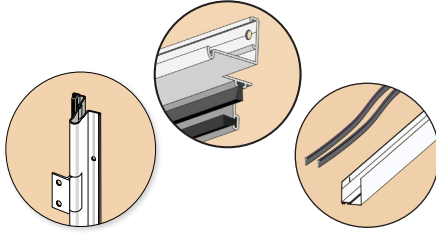

Tools needed:

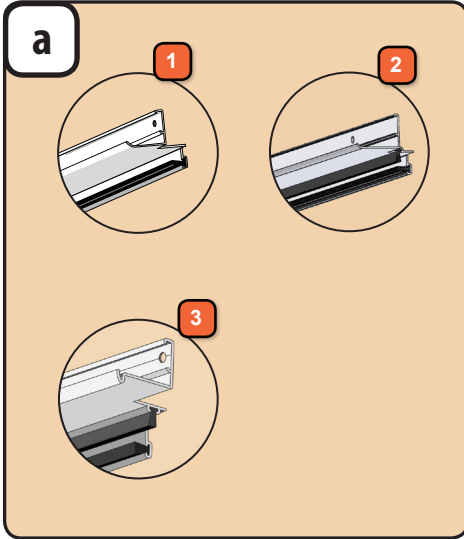
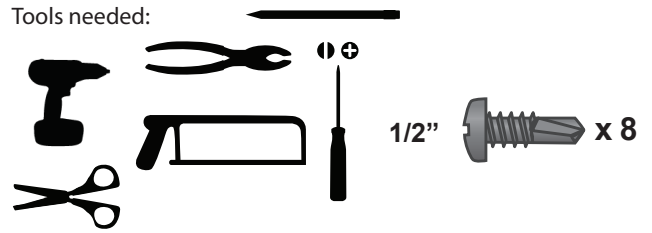

1. Identify rain cap (C) profile for hinge rail placement on door frame in **step b**.
2. If rain cap profile matches option 1 or 2 above, place hinge rail 1/8" above door frame. If rain cap profile matches option 3 above, place hinge rail 1/4" above door frame.

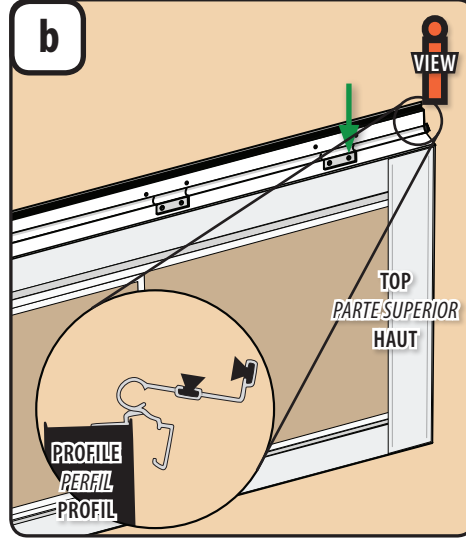

1. Identify the top of the hinge rail.
2. Position the hinge rail along the hinge-side edge of the door frame so the top of the hinge rail extends beyond the top of the door frame using measurements from **step a**.
3. Attach all four hinge leaves to the door frame using unpainted 1/2" screws.

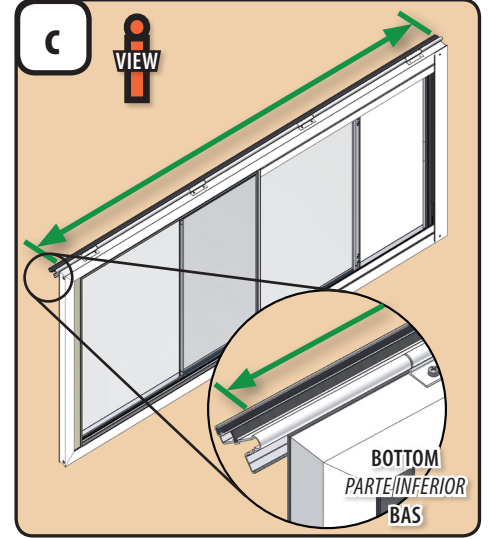

1. Measure the height of the door opening on the hinge side, measuring from the underside of the top door trim to the door sill and subtract 1/8" to account for installation of the rain cap after the hinge rail is installed onto mounting surface.
2. Measure the hinge rail, starting at the top and then marking the bottom with the measurement from door opening minus an 1/8".
3. Using a hacksaw, cut the hinge z-bar to length.

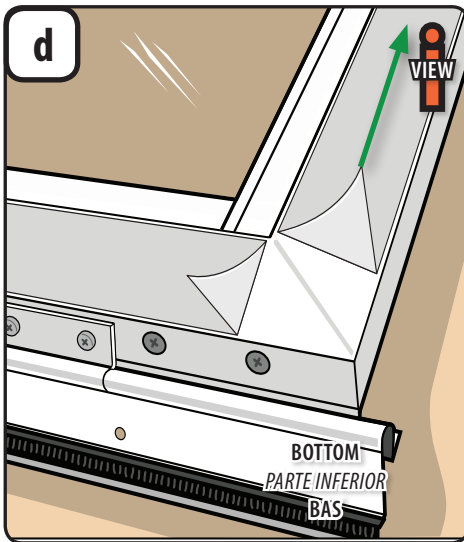

1. If applicable, remove the entire clear protective film from the interior bottom of the door frame and properly discard. Peel up the first few inches from both sides at the bottom.

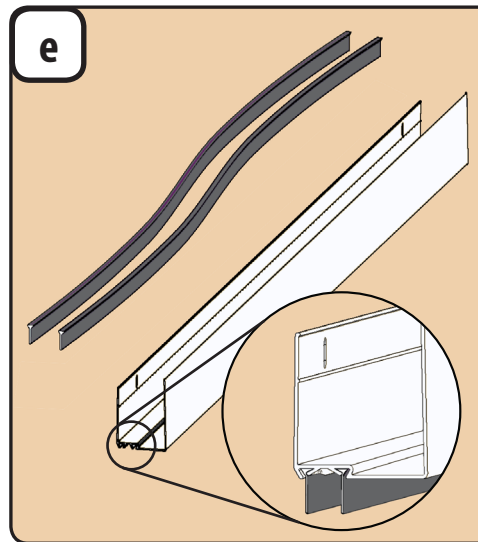

1. Slide the sweep fins into the tracks located on the bottom of the door sweep.
2. Using scissors, trim any excess sweep fin material that extends beyond the door sweep.
3. Using pliers, crimp each end of the tracks to prevent the sweep fins from coming out of the tracks.
4. Position the door sweep so that it is centered across the width of the door frame and pushed up against the bottom of the door.
5. Do not install the screws at this time.

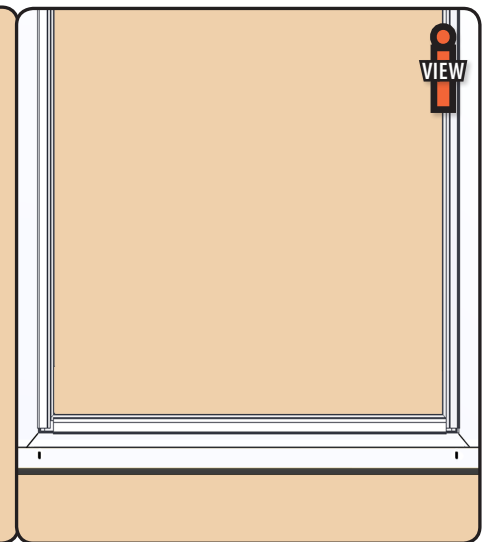

6

INSTALL FIXED STORM DOOR IN OPENING

Tools needed:



1/8" 

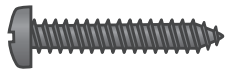

1"  x 17

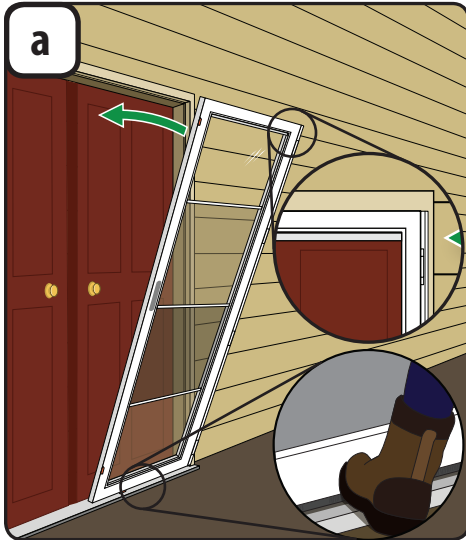

1. Set the door frame on the entry sill so the hinge rail is tight against the mounting surface or hinge rail shim.
2. While holding door in position, mark onto the mounting surface the location of the top-most pre-drilled hole in the hinge rail. Once marked, remove door from opening and set aside.
3. Using the 1/8" drill bit, drill a hole in the mounting surface where you placed the mark.

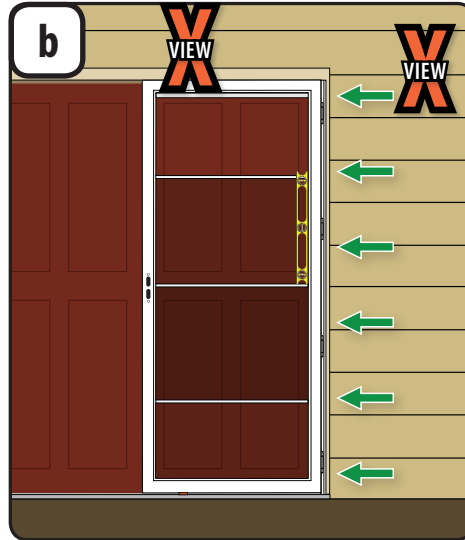

1. Reposition the door in the opening and align the pre-drilled hole in the hinge rail with the hole that you drilled in the mounting surface. Fasten the door to the mounting surface using one #8 x 1" screw from the yellow bag.
2. Using the level, make sure that the door is plumb. While holding door in position, use the 1/8" drill bit to drill holes in the mounting surface through the pre-drilled holes in the hinge rail.
3. Fasten the hinge rail to the mounting surface using five screws from the yellow bag.

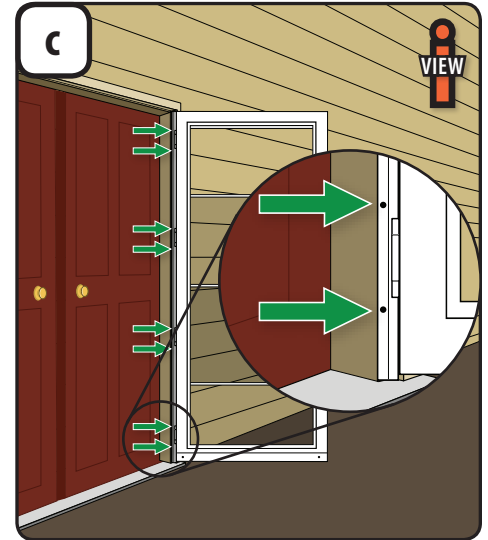

1. Open the storm door.
2. Pre-drill and fasten the hinge rail to the door jamb using 1" screws from the yellow bag.

**IF YOU ARE INSTALLING A FULLVIEW LAMINATED STORM DOOR
COMPLETE STEPS 7-9. ALL OTHER STORM DOORS PROCEED TO STEP 10.**

7 REMOVE THE LOCK AND EDGE SEAL

Tools needed: 



1. Remove the screws that attach the multi-point lock to the door frame.
2. Properly discard of the screws and multi-point lock assembly.

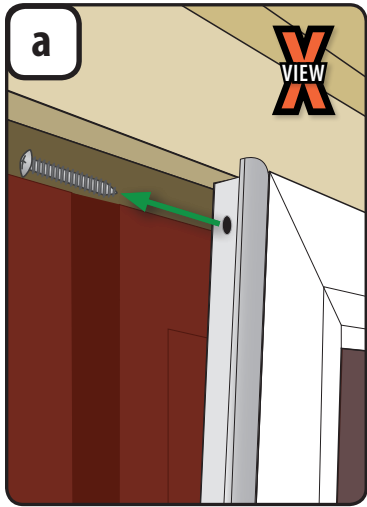

1. Remove the screws that attach the edge seal to the door frame.
2. Properly discard of the screws and edge seal

8 INSTALL ASTRAGAL INSERTS

Tools needed:   1/8"

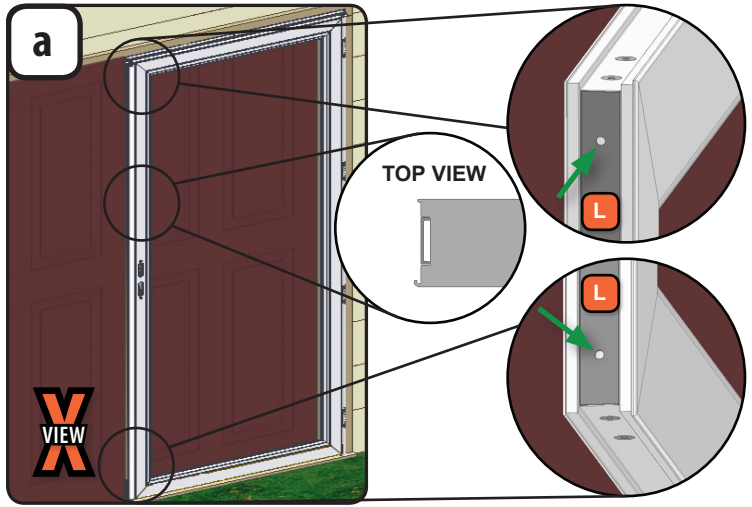

1. Place one astragal insert (L) flush with the top of the recessed edge of the fixed door on the handle side as shown. Make sure the end of the insert with the hole nearest the end, is at the top of the door. Using the pre-drilled holes in the insert, drill four 1/8" pilot holes into the door frame. Attach the insert with four #8 x 1/2" screws provided in the astragal kit.
2. Place the second astragal insert flush with the bottom of the recessed edge of the fixed door on the handle side as shown. Make sure the end of the insert with the hole nearest the end, is at the bottom of the door frame. Using the pre-drilled holes in the insert, drill four 1/8" pilot holes into the door frame. Attach the insert with four #8 x 1/2" screws provided in the astragal kit

9 INSTALL LOCK CASE

Tools needed:  1/8" 

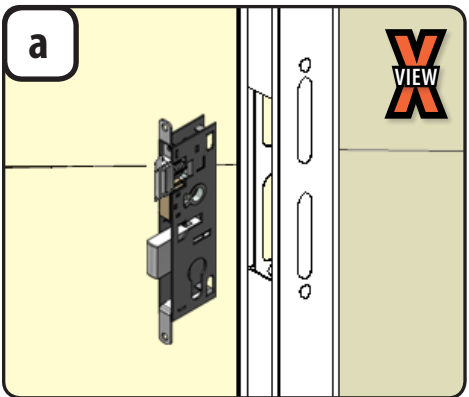

1. Find the lock case that was packaged in the kit (not with the storm doors) and insert it into the slot in edge of door. Orient lockcase with latch bolt above deadbolt and install using two #8 x 1/2" Phillips pan head self-drilling screws.

10 ASSEMBLE HANDLES

Tools needed:  1/8" 

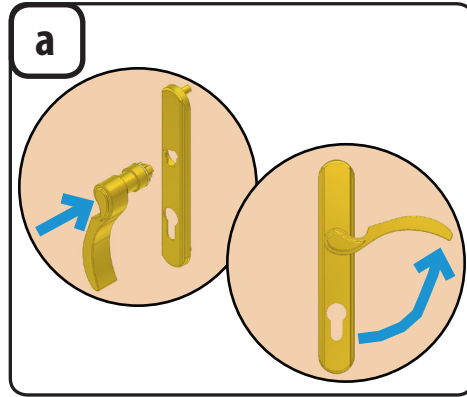

- NOTE:** Trim plate should not be installed on the door while completing steps.
1. Insert handle into outside trim plate (with Andersen logo) with lever pointing down and rotate the handle to secure it.

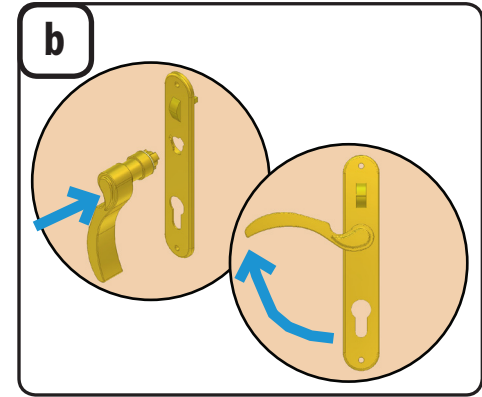

- NOTE:** Trim plate should not be installed on the door while completing steps.
1. Insert handle into inside trim plate (with slider) with lever pointing down and rotate the handle to secure it.

11

REMOVE PROTECTIVE TAPE FROM FIXED DOOR AND INSTALL HANDLE SET

Tools needed:

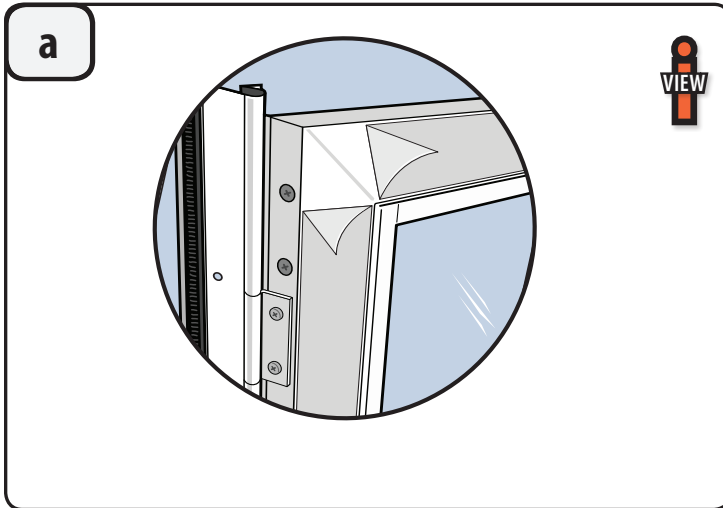

1. Remove protective film from both the interior and exterior sides of the fixed door frame.

You can match your Andersen storm door lock to Schlage® or Kwikset® entry door locks. See handle set instructions contained within handle set box for details.

“Kwikset” is a registered trademark of Newfry LLC. “Schlage” is a registered trademark of Schlage Lock Company.

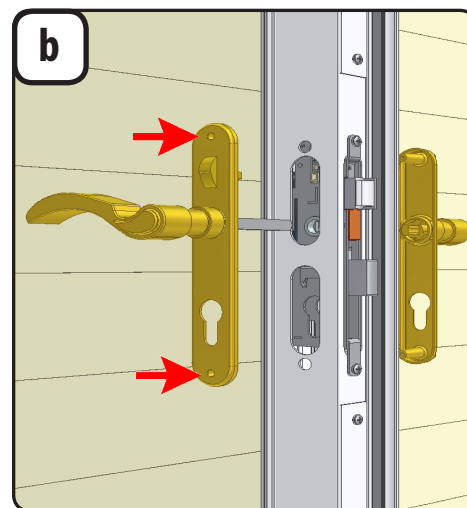

1. With handle levers held horizontal, install both handle assemblies onto the door. The spindle will pass through the square hole in the lock case and into the other handle. Attach trim plates together using two #8 x 1 1/2” screws.

NOTE: The slider above the interior handle is only used on certain models. Please refer to the installation guide that came with the storm door.

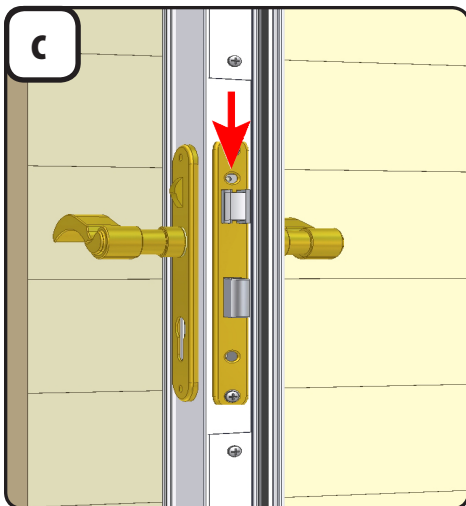

1. Install lock case trim plate onto lock case and fasten with one #10 x 5/8” screw. Do not overtighten.

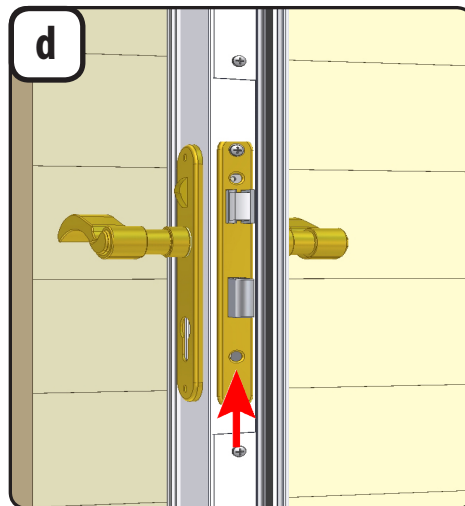

1. Insert dead bolt key cylinder into lock case and fasten with one #10 x 1 1/2” screw. Do not overtighten.

NOTE: This door features an integrated latch receiver in the latch rail, eliminating the need for a traditional, separate strike plate

12 REMOVE EDGE SEAL FROM FIXED DOOR

Tools needed:

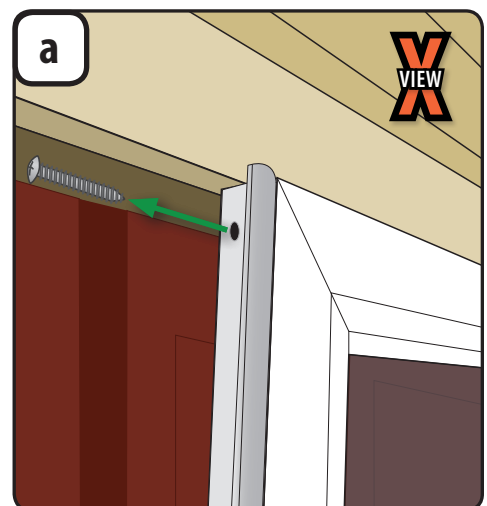

NOTE: Disregard if you have a Fullview Laminate door.

1. Remove the screws that attach the edge seal to the door frame.
2. Properly discard of the screws and edge seal.

13

CUT FIXED ASTRAGAL TO LENGTH

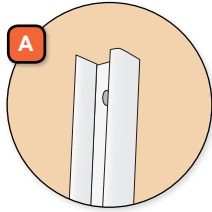

Tools needed:

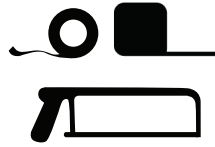

14

DRILL HANDLE SET LATCH HOLES

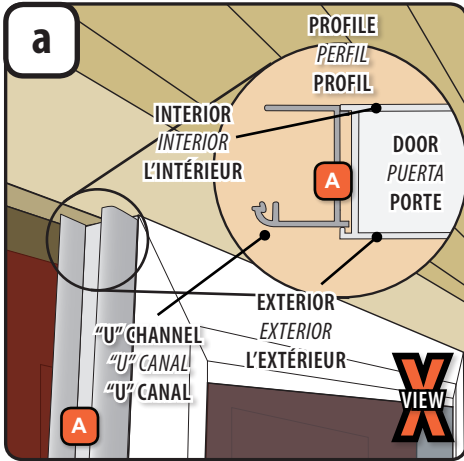

1. Temporarily position fixed astragal (A) on edge of fixed door as shown.
2. Determine which end will be top and mark with small piece of tape.

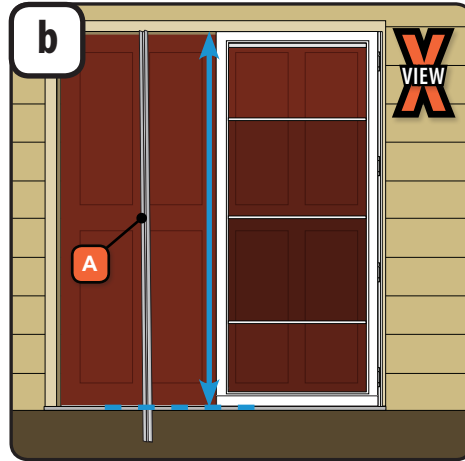

1. Measure distance from top of door to bottom of door to decide length of fixed astragal piece.
2. Measure this distance from top end of fixed astragal and mark cutting line.
3. Cut fixed astragal using a hacksaw.

1. If you are installing a double door for an Andersen 1 1/2" Fullview or Fullview with Insulating Glass with the quick release window system, refer to the drill template and instructions located in the Astragal Drill Kit that was included with your double door assembly.
2. If you are installing any other style of door, discard the Astragal Drill Kit and proceed to the next step.

15

INSTALL FIXED ASTRAGAL TO FIXED DOOR

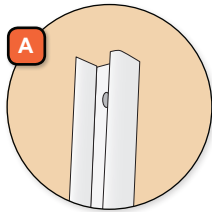

Tools needed:

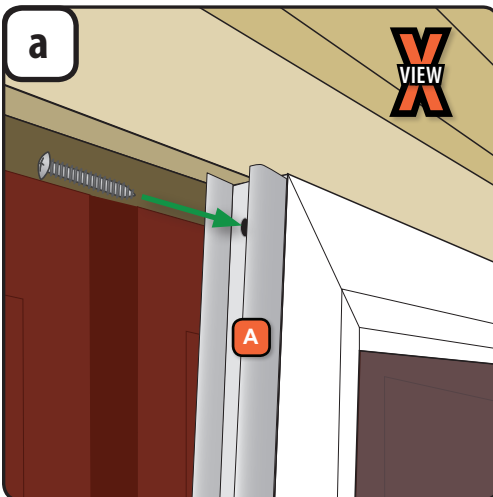
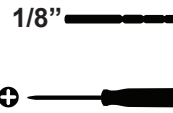

1. Align top end of fixed astragal with top edge of door. **NOTE:** Will not be completely flush with top of door.
2. Drill a 1/8" pilot hole through the center of the top pre-punched hole in the fixed astragal and into the door frame. Install one 1" screw from the door installation kit.



1. Drill a pilot hole through the center of the first pre-punched hole above the lockset. Install one 1" screw.
2. Before drilling the rest of pilot holes, close door to check for interference. If interference occurs, it may be necessary to remove fixed astragal and re-cut bottom.
3. Once satisfied, drill pilot holes and install 1" screws in remaining holes.

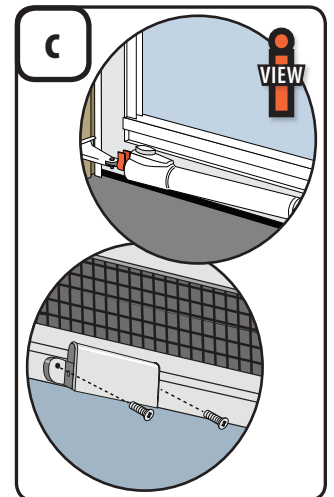

1. Set aside window handle (if applicable) and closer for later. Do not discard.

16

CUT ASTRAGAL JAMB

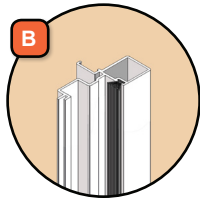

Tools needed:

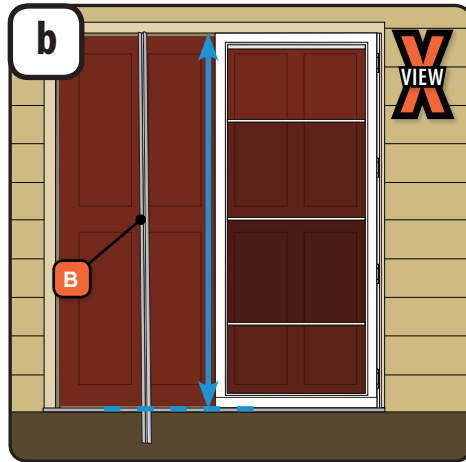
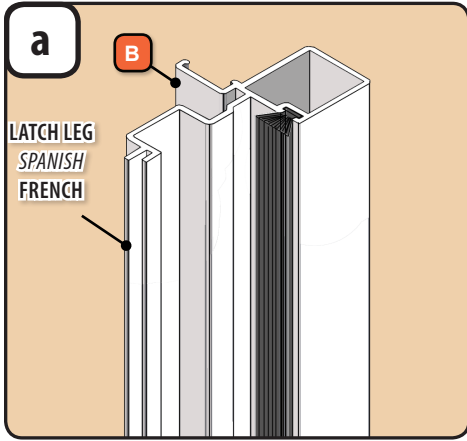
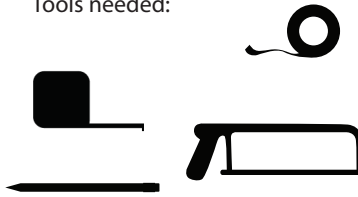

1. Determine the top of astragal jamb (B). The weather pile edge of astragal jamb faces the exterior. The latch leg slides into the "U" channel on fixed astragal. Hold astragal jamb up to fixed astragal to determine top. Mark with small piece of tape.

1. Measure down from the top of the fixed astragal to the top of the door sill. Subtract 3/8" and cut to length.

17

INSTALL ASTRAGAL JAMB TO FIXED DOOR

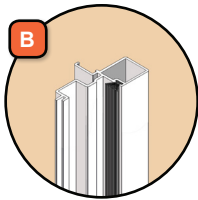

Tools needed:

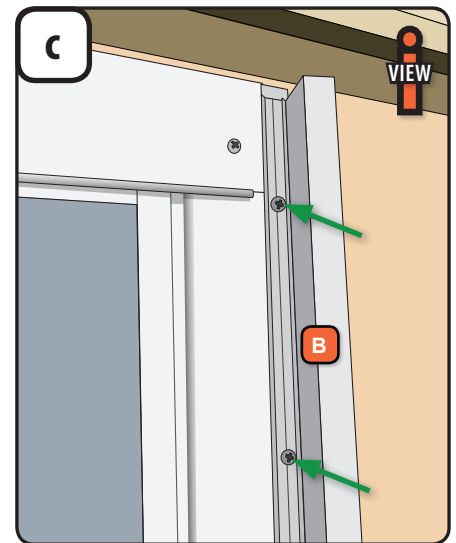
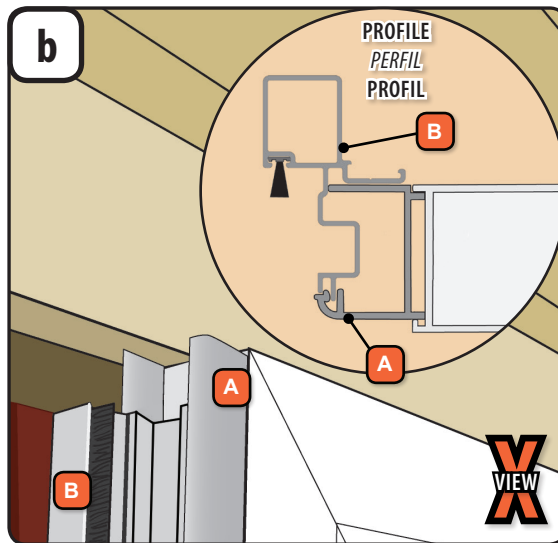
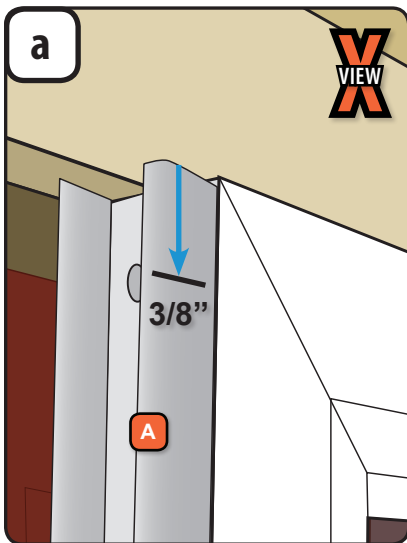
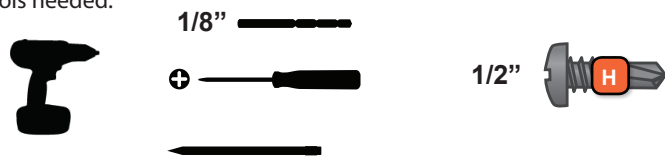

1. Measure down from the top of the fixed astragal (A) 3/8" and mark a line on the fixed astragal at that point.

1. Attach the astragal jamb (B) to the fixed astragal and align it with the line from the last step.
2. Close the door to check for interference. If there is interference, you will have to trim the astragal jamb.

1. Drill 1/8" pilot holes through the pre-punched holes in the jamb and into the fixed astragal.
2. Install the 1/2" screws that came with the astragal kit (I).

18

PREPARE FUNCTIONAL DOOR FOR INSTALLATION

1. Lay carton down on a flat surface and carefully open door pack per the instructions on the carton.
2. Refer to Step 5 to attach hinge rail to functioning door.

19

PLACE SPACER BLOCKS ON ASTRAGAL JAMB AND SET DOOR IN OPENING

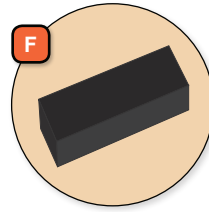

Tools needed:

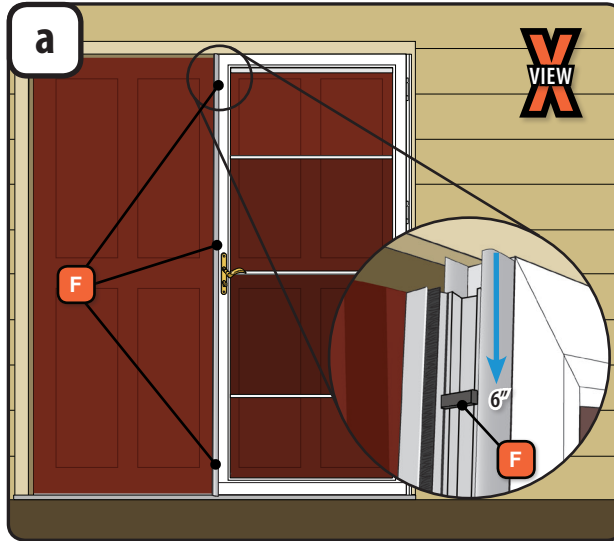

1. Place spacer blocks (F) from astragal kit on the astragal jamb.
2. Place one 6" from top, one 6" from bottom, and the last one above the handle set.
3. To attach spacer blocks, remove tape backing from each one and affix to the astragal jamb.



1. Set door frame on entry sill so hinge rail is tight against mounting surface and sitting on the door sill.
 2. Tip top of door frame into opening.
- NOTE:** Door may be out of square at this time.

20

ADJUST FUNCTIONING DOOR AND INSTALL SCREWS

Tools needed:



1/8"



1" x 14

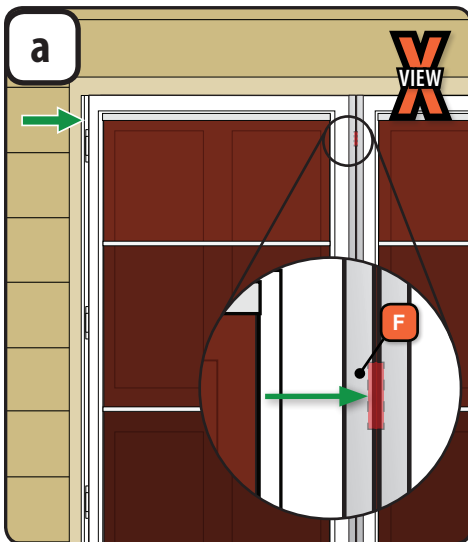

1. Push functioning door over towards fixed door until it contacts the spacer block (F) on the astragal jamb.
2. Install a 1" screw from the door installation kit into top hole location of hinge rail.

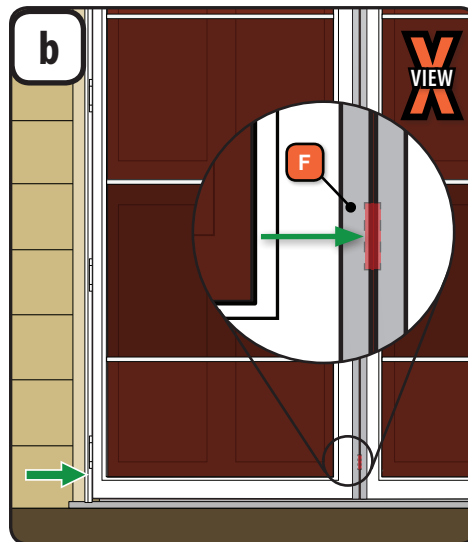

1. Push bottom of functioning door over towards fixed door until it contacts the spacer block on the astragal jamb.
2. Install a 1" screw into bottom hole location.

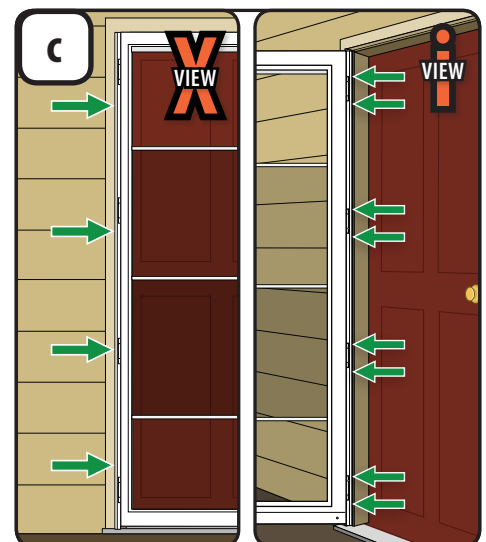

1. Install remaining hinge rail screws.

21 REMOVE SPACER BLOCKS

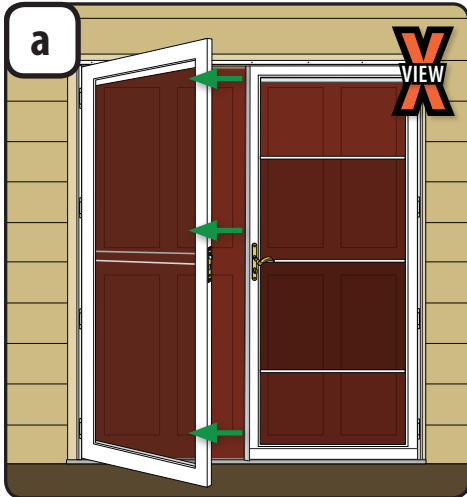

1. Open functioning door and remove all three spacer blocks from the astragal jamb.

22 REMOVE PROTECTIVE TAPE FROM FUNCTIONING DOOR AND INSTALL HANDLE SET

Tools needed:

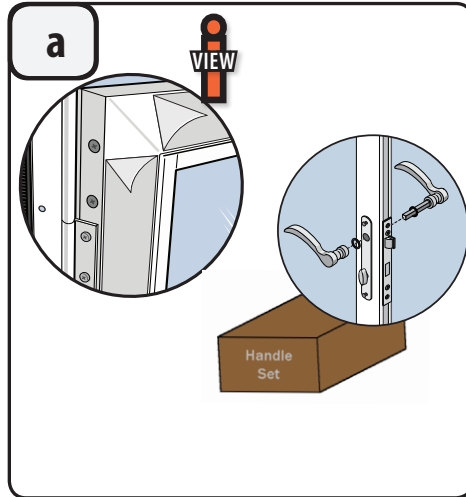

1. Remove protective film from both the interior and exterior sides of the fixed door frame.
2. Refer to Steps 10 & 11 to install the door handles.

23 INSTALL ASTRAGAL RAIN CAP

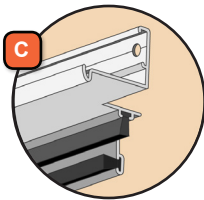

Tools needed:

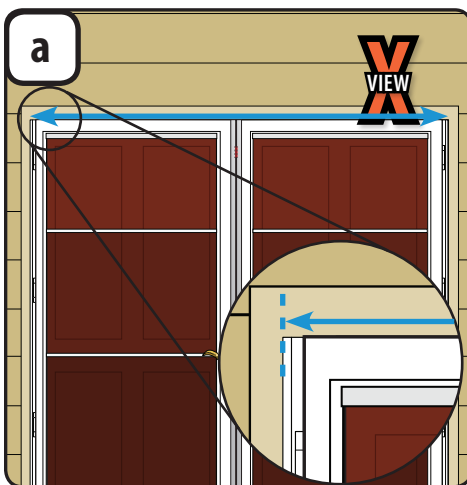
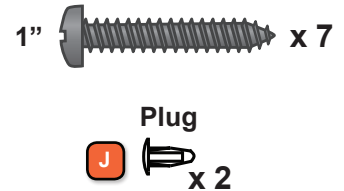

1. The ends of the astragal rain cap (C) have been pre-notched to fit either a double 36" doorway or a double 42" doorway, depending on your astragal kit.
2. If you are installing two 36" doors or two 42" doors, proceed to **step c**. If not, you will need to cut off a portion of the rain cap.
3. Measure the opening width at the top from the edge of one hinge rail to the other.

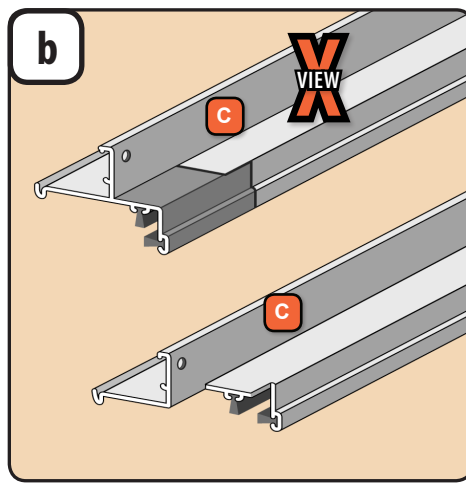

1. Cut the rain cap to the length you found in **step a**.
2. Now use the cut off end of rain cap as a template to re-notch your rain cap.

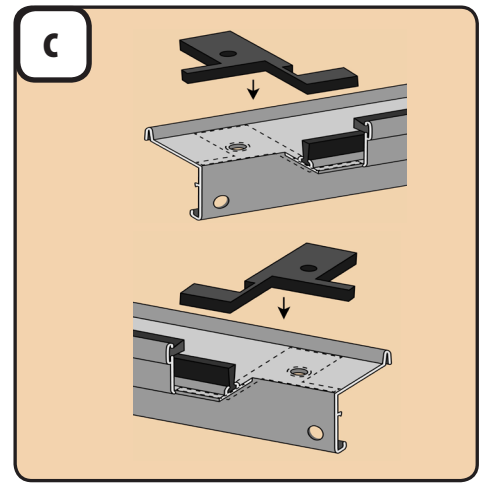

1. Place the new rain cap on top of the mounting rails and measure the gap between the door frame and rain cap. If the gap is less than 1/8" (i.e. the door will not open without hitting the rain cap), install the spacers as shown in the image above. If the gap is greater or equal to 1/8", skip this step and proceed to **step 23d**.

23

INSTALL ASTRAGAL RAIN CAP (CONTINUED)

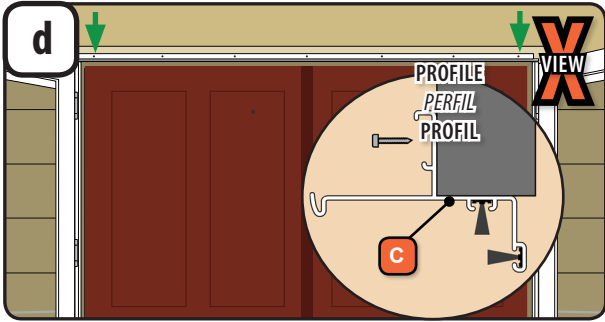

1. Open both doors.
2. Position rain cap at the top of the doors so it rests on the top of the hinge rails and flush with the edges.
3. Holding the rain cap in place, drill a 1/8" pilot hole through the mounting hole on one end of the rain cap and install a 1" screw from the installation kit.
4. With rain cap setting on top of hinge rail, fasten rain cap on opposite end.

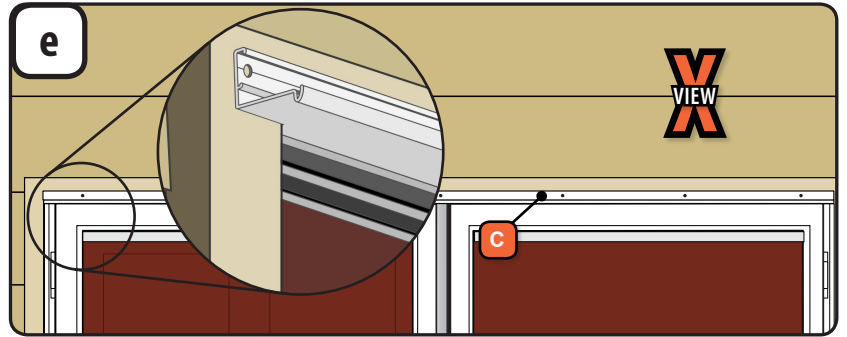

1. Close the storm doors and adjust the rain cap to achieve an even gap between the top of the door frames.
2. Using a drill and 1" screws from the installation kit, fasten the rain cap to the mounting surface.

24

INSTALL SLIDE BOLTS AND SLIDE BOLT STRIKERS

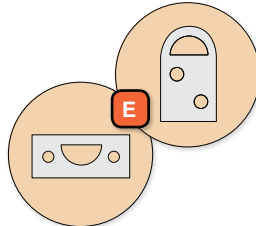
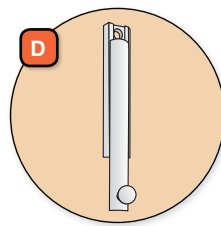

5/8" **I** x 8

Tools needed:

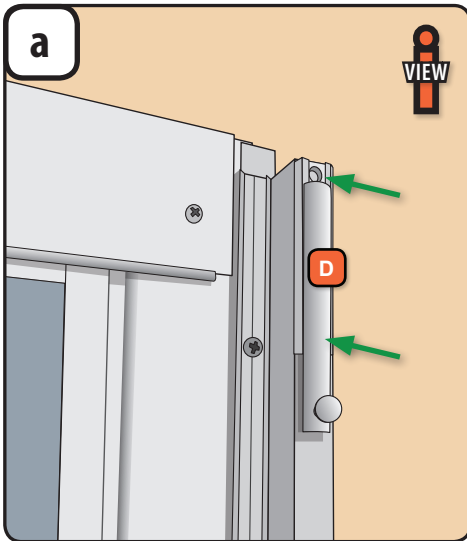

1. On interior of fixed door, center one slide bolt (D) at the top of interior face of astragal jamb. When slide bolt is retracted, the end of the bolt housing should be flush with top of astragal jamb.
2. Mark the location of the top hole and drill a 3/32" pilot hole. Then install a 5/8" screw (I) from the astragal kit.
3. Slide the bolt up, drill a pilot hole through bottom hole, and install another 5/8" screw.
4. Be sure screws are completely countersunk so that the slide bolt functions properly.
5. Repeat this procedure at the bottom of the astragal jamb.

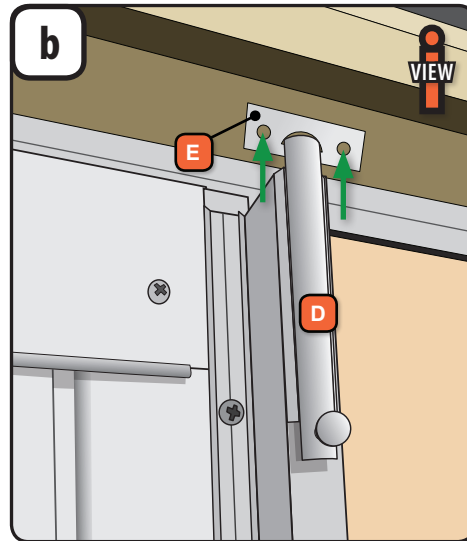

1. Install striker (E) at top first. Close door so that weather pile on rain cap is slightly compressed. Holding door in this position, slide bolt up until it contacts door header jamb. Trace around bolt with pencil.
2. Determine which of the two types of strikers will work best for your application. Position striker over traced line and mark location of mounting holes with pencil. Drill two 3/32" pilot holes for the two 5/8" mounting screws. Drill and/or chisel a recess of approximately 3/4" deep into door jamb for bolt to slide into. Attach striker with screws provided. Check to be sure that bolt passes through striker.

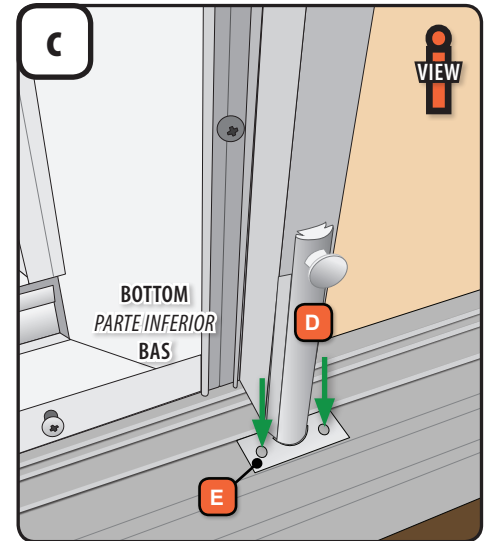

1. Close door and lock slide bolt at top. Using a level, move door in or out slightly until door is vertical.
2. With door in this position, mark and install slide bolt striker on door sill in same manner as the one on door header jamb.
3. Check to make sure both slide bolts function correctly.

25

REMOVE TAPE FROM WINDOWS (If applicable)

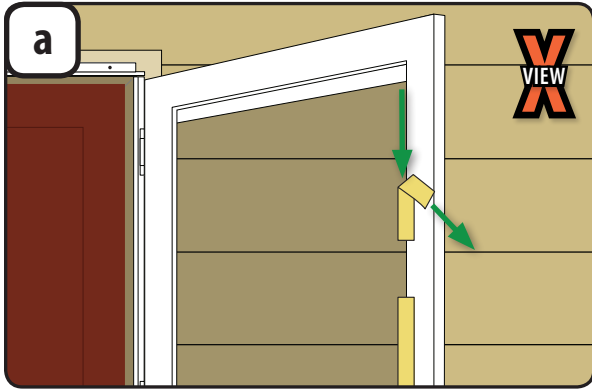

1. Remove all remaining protective tape from doors and windows.

26

INSTALL WINDOW HANDLES (If applicable)

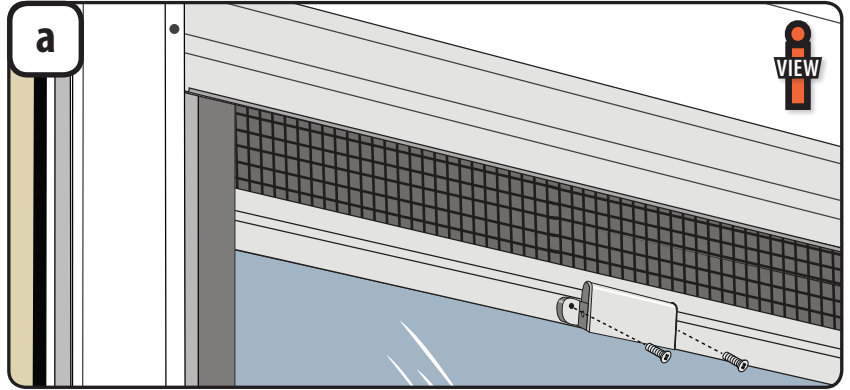
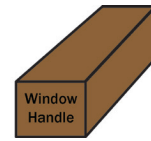

1. Lower or raise the ventilating glass panel so that the holes below the insect screen are at a comfortable working height.
2. Refer to the instructions included in the Window Handle Kit to install the window handle.
3. Repeat above steps for second door.

27

ADJUST SWEEP (Left Hand) (If necessary)

Tools needed:

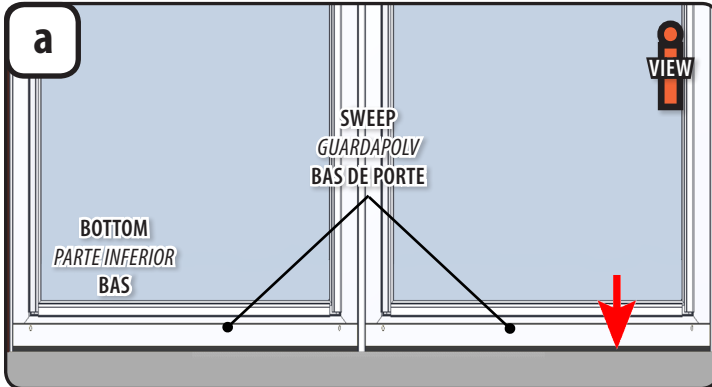

1. Close the storm doors.
2. From interior, adjust each sweep up or down until sweep fin lightly comes into contact with door sill.
3. Using a drill and the 1/8" drill bit, drill two holes in the center of the pre-punched slots in sweep.
4. Fasten the sweep to the door using two 1/2" color-matched screws located in the installation kit.

28

INSTALL CLOSERS

Tools needed:

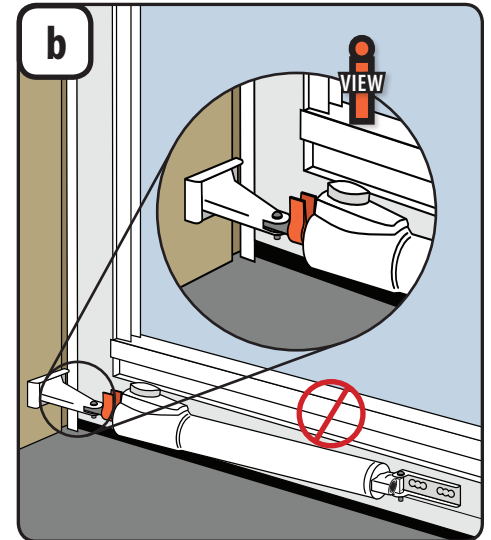
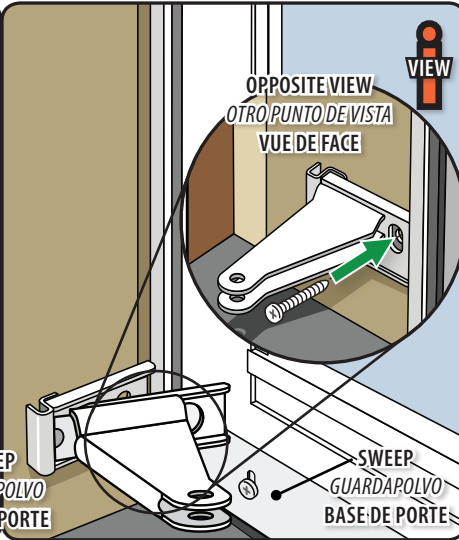
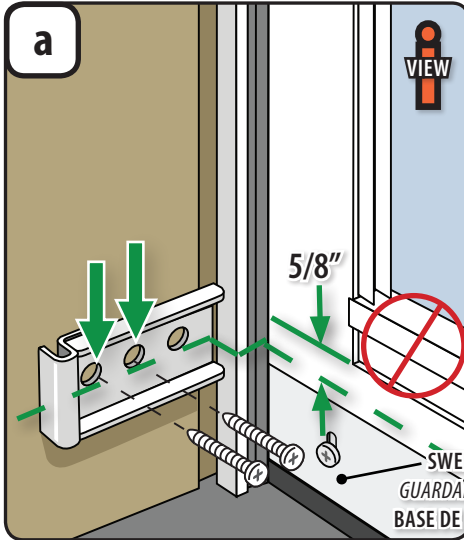
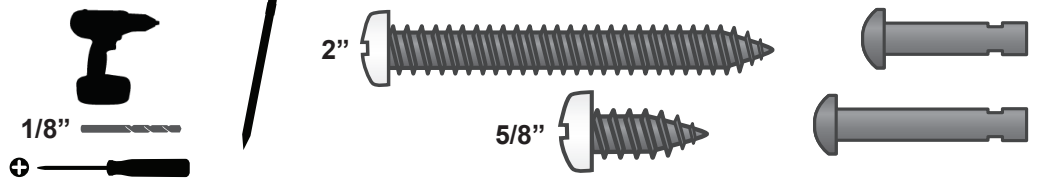

1. Measure 5/8" below the window opening at the bottom on the hinge side and mark a line on the sweep or door frame. Extend the line onto the door jamb.
2. Center the jamb bracket base on this line by touching the front of the jamb bracket base to the back of the hinge rail.
3. Using the 5/32" drill bit, drill holes in the door jamb through each of the three pre-punched holes in the jamb bracket base.
4. Attach the jamb bracket base to the door jamb with two #10 x 2" screws into the two holes closest to the interior of the house.
5. Attach the arm from the installation kit to the base by inserting the tabs on the arm into the slots in the base. Fasten with a 2" screw from the green bag.

1. Pin the closer in place using the short pin in the jamb bracket and the long pin in the door bracket.
2. Pull on the closer so the rod extends slightly. Snap the orange preload clip from the installation kit over the rod. The clip should be pinched tight between the closer cylinder body and the jamb bracket.

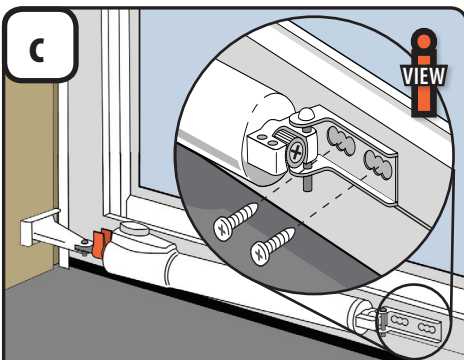

CAUTION

Do not drill completely through door. This will create an unnecessary hole in the door and may cause water and air infiltration.

1. Close the storm door. Swing the closer assembly over until the door bracket is resting against the door frame and is level. Mark hole locations through the center of the door bracket slots onto the door frame.
2. Using the 5/32" drill bit, drill holes and attach the closer door bracket to the door frame through the two pre-drilled holes using two 5/8" screws from the green bag.
3. Remove orange preload clip and properly discard.

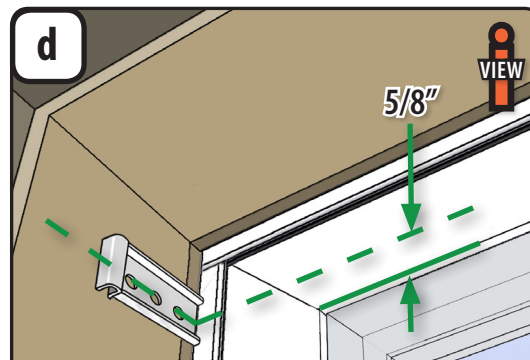

CAUTION

Do not install closer at the top of doors with a retractable insect screen. This will damage the insect screen and may cause it to not function properly.

If applicable, repeat steps a-c to install top closer 5/8" above window opening.

1. After the installation is complete, replace the bump closer with the standard closer at the top.
2. Re-install the bump closer at the bottom.

Repeat steps a-e to install the closers on the other storm door.

29

INSTALL EDGE SEAL (Left Hand)

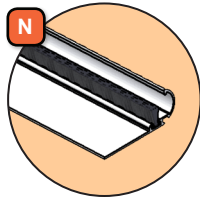

Tools needed:

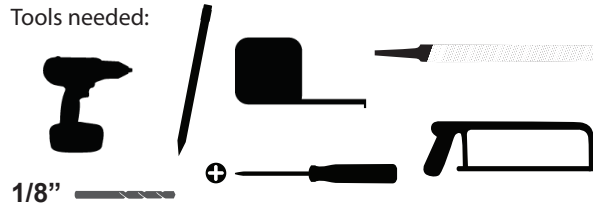

PINK BAG // BOLSA ROSA // SAC ROSE

1/2" #8 x 7

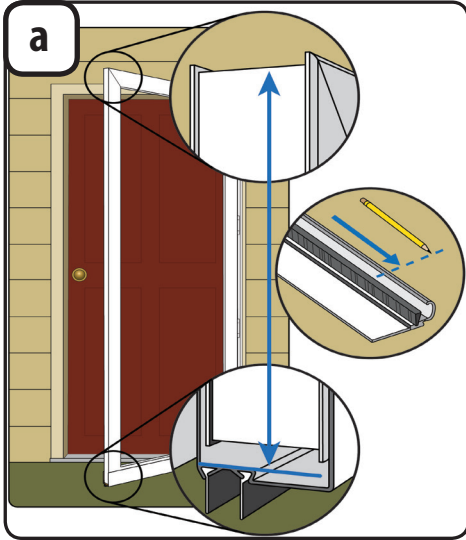

1. Hold edge seal (N) up to handle side of door so round side faces the exterior and weather pile seals against handle side Z-bar. Mark top of edge seal with a piece of tape.
2. Measure from top of door to the inside lip of sweep. With this measurement, measure from top of edge seal, mark a cutting line and cut at mark.

WARNING

Generously round the bottom corners of the edge seal with a metal file to avoid sharp edges. Failure to round the bottom corners may cause an injury.

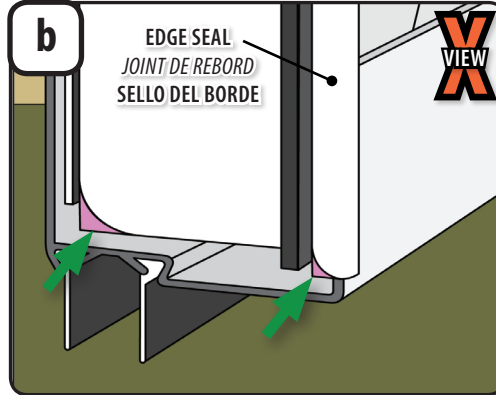

1. File the bottom corners of the edge seal until it's smooth.

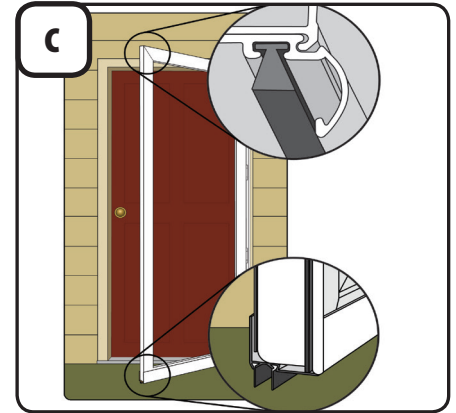

1. Open the door and place the edge seal on the latch side of the door as shown. The rounded face of the edge seal should be to the exterior. Make sure the end of the edge seal is flush against the door frame lip.
2. Slide the edge seal up so that it is flush with the top of the door, not the door frame lip. Drill a 1/8" pilot hole through the mounting holes and into the door frame edge.
3. Fasten edge seal with seven (7) #8 x 1/2" painted screws from pink bag.

30

INSTALL SCREW COVERS (Left Hand)

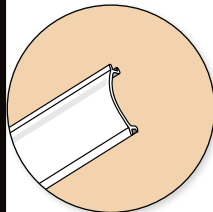

Tools needed:



31

ADJUST CLOSING SPEED OF DOOR

Closer and door shown are for reference only.

Tools needed:

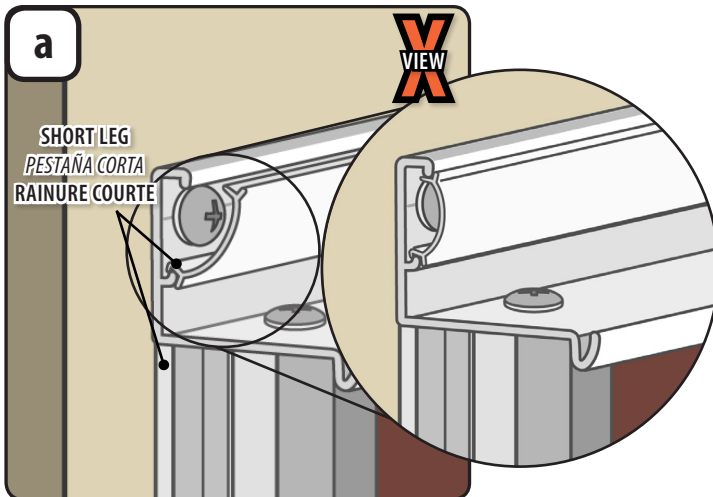
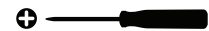

1. Lock leg of screw cover into short leg of rain cap screw track. Press on other leg to snap it into long leg of track. Make sure screw cover snaps into screw track along the entire length of the rain cap.
2. Repeat this process with remaining side screw covers.
3. Using scissors, trim off any excess that may remain.

WARNING

Storm door will close more quickly when entry door is open. To achieve the proper closing speed, you will need to adjust the closer(s) using the built-in adjustment screw. Check for safe closing speed with your entry door in both the closed and the open position. To prevent injury, make sure people and/or pets are completely through the opening before allowing the storm door to shut freely.

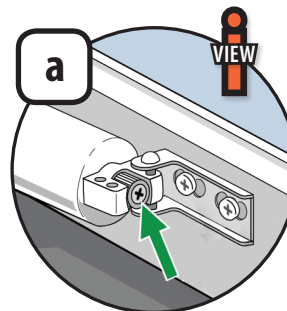

1. Open the door and then let it close. Note the speed at which the door closes.
2. Using a Phillips head screwdriver to adjust the closer to the desired speed: For a faster closing speed, turn the adjustment screw to the left (counterclockwise). For a slower closing speed, turn the adjustment screw to the right (clockwise).
3. Test the speed at which the door closes after each adjustment. Adjust the screw more, if needed, to achieve the desired door closing speed.