

Installation Guide

Replacement Long Sill Adapter for Andersen® LuminAire™ Retractable Insect Screen Door

For installation help please visit www.AndersenLuminAire.com/install



Please Do Not Return Product to Store!

PLEASE call the Storm Door Solution Center at 844-813-6664, with any questions regarding installation, lost part replacement, or anything else related to your retractable insect screen purchase. Replacement parts can also be found at: parts.andersenstormdoors.com

Read this entire guide before you begin your installation. If your abilities do not match the requirements of this installation, contact an experienced contractor.

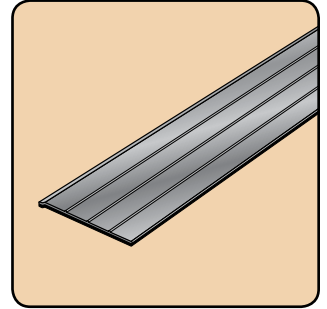

PARTS OVERVIEW

Your replacement part should contain the following parts.

1 Long Sill Adapter

2 **Not Shown**

Screw Pack *containing:*

- ½ inch #8 self-tapping screws (qty 3)

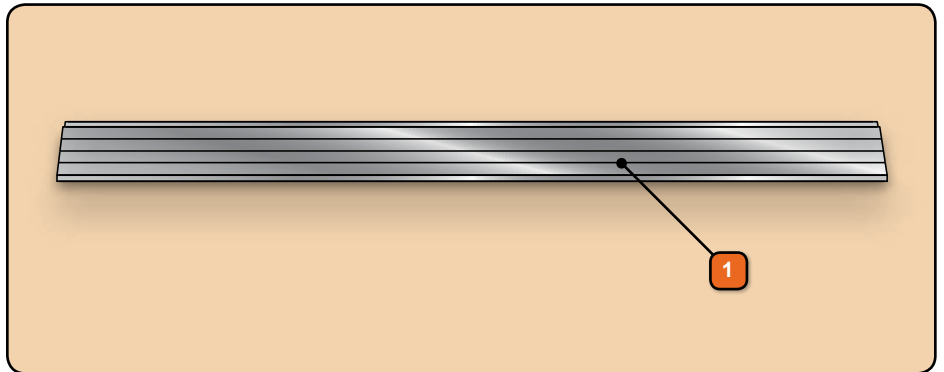

SAFETY FIRST: Please read and follow all Cautions and Warnings in this guide.

RECOMMENDED TOOLS

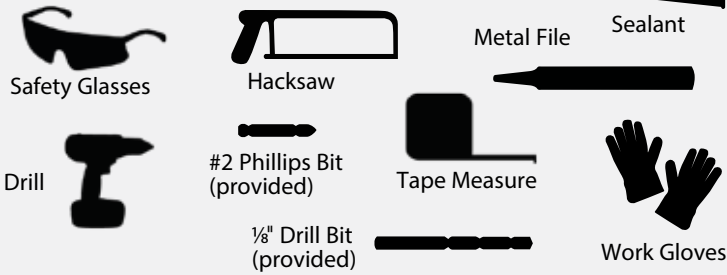

This is the Safety Alert Symbol used to alert you to potential injury hazards. Obey all safety messages that follow this symbol to avoid possible injury or death.

Signal Word and Consequence

COULD Result in:	WARNING Major Injury / Death	COULD Result in:	CAUTION Minor Injury
COULD Result in:	NOTICE Product or Property Damage	IMPORTANT Procedure and Product Information	

WARNING

Follow manufacturers' instructions for hand and power tools. Always wear safety glasses. Failure to do so could result in injury, product or property damage.

CAUTION

Metal components of the retractable insect screen may become hot when exposed to sunlight.

IMPORTANT

The retractable insect screen is intended for reasonable insect control and not the retention of objects, persons, or pets within the interior. The retractable insect screen will not stop a person from falling through the door.

1 REMOVE SILL ADAPTER AND PREPARE THE REPLACEMENT

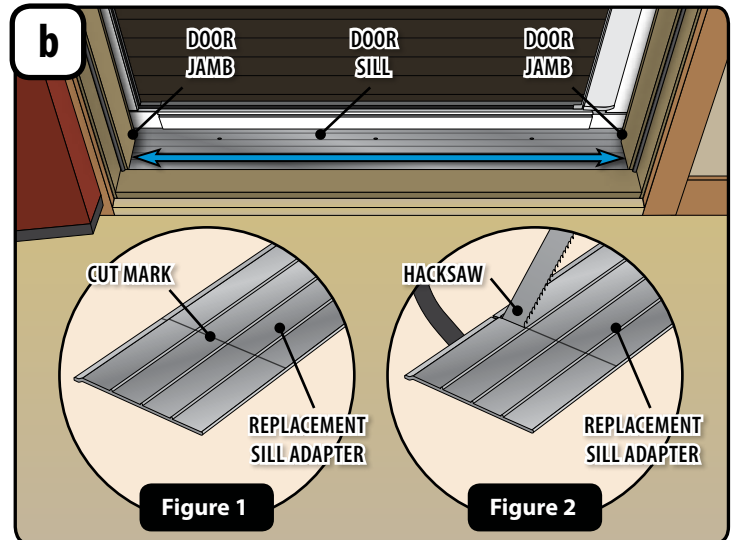
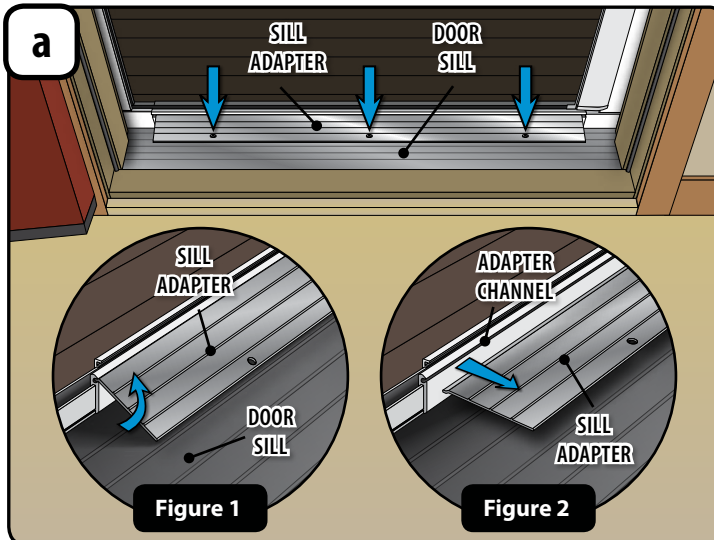

- a1** From the interior of the screen assembly, remove the three screws from the Sill Adapter.
- a2** Rotate the Sill Adapter up and pull it out of the Adapter Channel (see Figures 1 and 2).
- a3** Save the Sill Adapter for reference in future step.

- b1** Measure from Door Jamb to Door Jamb across the Door Sill, to determine the length the replacement Sill Adapter needs to be cut down to. Reduce the length by a minimum of 1/4 inch to allow room for expansion.
- b2** Mark the length on your replacement Sill Adapter. (see Figure 1).
- b3** With the Hacksaw make a clean square cut through the Sill Adapter at the Cut Mark. With a metal file, file down all sharp edges (see Figure 2).

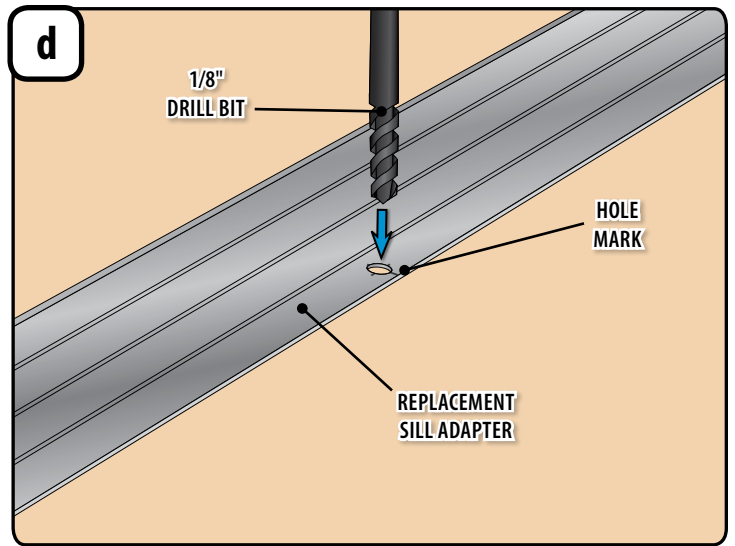
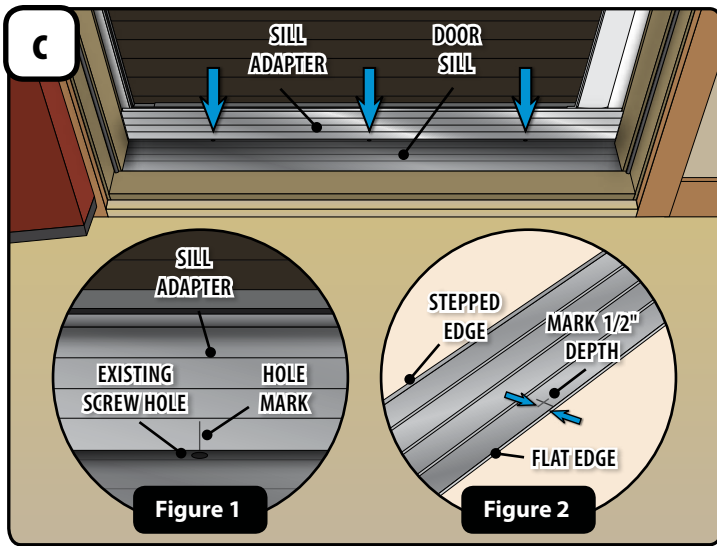

- c1** To mark the location of holes needed on the replacement Adapter Sill, place it onto the Door Sill with textured side facing the interior. Place the Flat Edge down over the Existing Screw Holes on Door Sill, and the Stepped Edge up centering the Sill Adapter in the door opening.
- c2** With the Sill Adapter centered, make a Hole Mark at each of the existing screw holes in the Door Sill. (see Figure 1).
- c3** At each Hole Mark measure in 1/2 inch from the Flat Edge of the Sill Adapter and mark the depth. (see Figure 2).

- d1** If possible, confirm the Hole Marks by placing the existing Sill Adapter over the replacement Sill Adapter and confirming the hole locations. Dispose of existing Sill Adapter properly.
- d2** With a 1/8" Drill Bit make a hole at each of the Hole Marks on the replacement Sill Adapter.

2

PLACE AND FASTEN THE REPLACEMENT SILL ADAPTER



Replacement Sill Adapter

Tools Recommended:





#2 Phillips



SCREW PACK

#8 - 1/2"
(Qty 3)

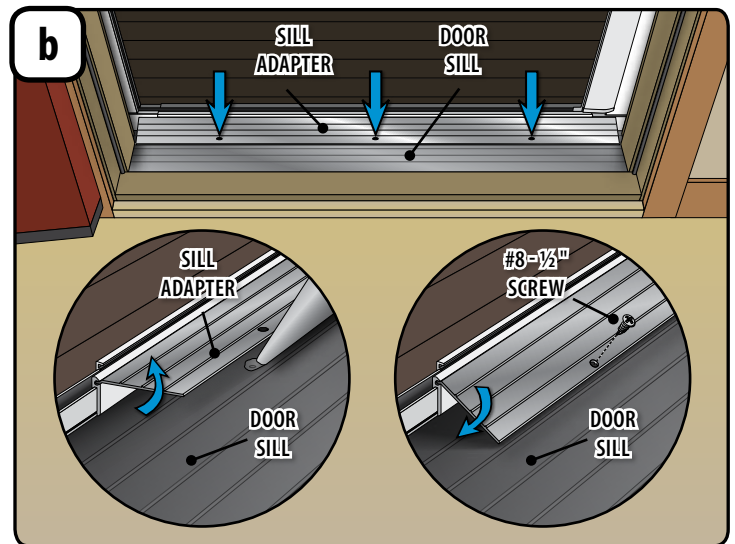
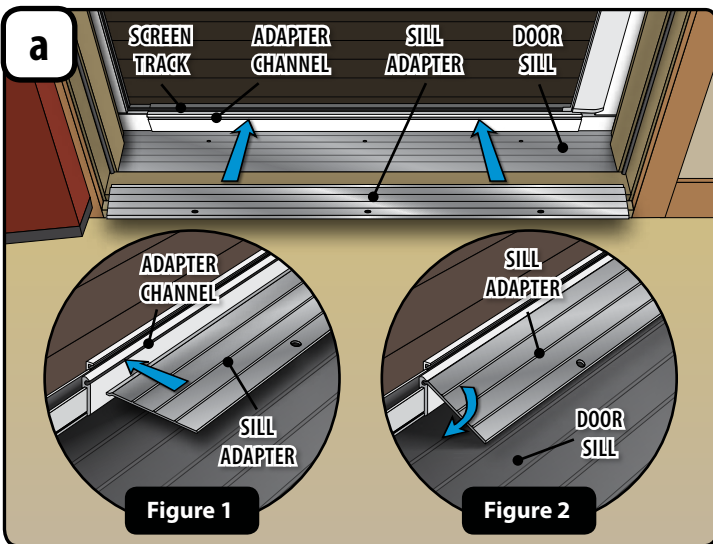



- a1** Thoroughly clean the Door Sill.
- a2** From the interior of screen assembly, position Sill Adapter with the textured side up and screw holes in toward the interior of the home.
- a3** Insert edge of the Sill Adapter into the Adapter Channel located on the Screen Track (see Figure 1).
- a4** Rotate the Sill Adapter down to the Door Sill to make sure the three holes in the Sill Adapter align with the three existing holes in your Door Sill. (see Figure 2).

- b1** Lift Sill Adapter and apply sealant into the holes until sealant overflows onto Door Sill surface.
- b3** Rotate the Sill Adapter back down to the Door Sill and fasten using three #8 - 1/2" Self-Tapping Screws. Cleanup excess sealant.

LUMINAIRE™
RETRACTABLE SCREEN DOOR

WINDOWS • DOORS
Andersen® 

1-844-813-6664