

# Replacement Guide

## for Stationary Window on Self-Storing Door with Retractable Insect Screen



### Please Do Not Return Product to Store!

**PLEASE call the storm door Solution Center at 1-800-933-3626,** with any questions regarding installation, lost part replacement, or anything else related to your storm door purchase.

**Read this entire guide before you begin your installation. If your abilities do not match the requirements of this installation, contact an experienced contractor.**

### PARTS OVERVIEW

Your installation kit should contain the following parts.

**A** Lower Stationary Window Replacement

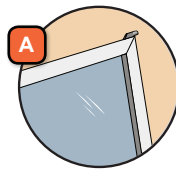

### SAFETY FIRST: Please read and follow all cautions and warnings in this guide.

#### **WARNING**

Improper use of hand or power tools could result in injury and/or product damage. Follow equipment manufacturer's instructions for safe operation. Always wear safety glasses.

#### **WARNING**

If you are replacing this window due to breakage or cracking, take caution as glass may break further and potentially cause personal injury. Tape broken glass with filament or duct tape before removal to reduce glass fragmentation.

#### **WARNING**

Wear gloves, safety glasses or eye shields when handling glass. Failure to do so may result in severe personal injury.

#### **WARNING**

Weight of window and door unit(s) and accessories will vary. Use a reasonable number of people with sufficient strength to lift, carry, and install window and door unit(s) and accessories. Always use appropriate lifting techniques.

### RECOMMENDED TOOLS

Safety Glasses



Gloves



Filament or Duct Tape

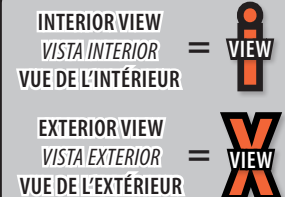

# EMCO®

EMCO Enterprises, Inc., is a wholly owned subsidiary of Andersen Corporation. EMCO manufactures and supports the limited warranties for Andersen® and EMCO® doors. "Andersen", "EMCO" and all other marks where denoted are trademarks of Andersen Corporation. ©2014 Andersen Corporation. All rights reserved.

Andersen SDD, PO Box 853  
Des Moines, IA 50306-0853  
Rev 1-2014 12043 Print in B&W

## p/n 504299

**1 POSITION UPPER VENTILATING WINDOW**

Tools needed:



**2 REMOVE LOWER STATIONARY WINDOW**

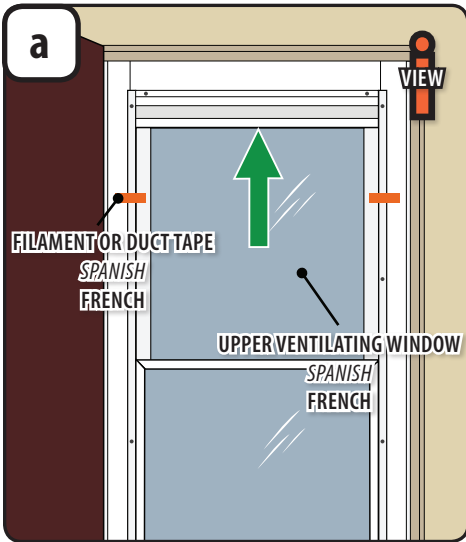

1. Raise the upper ventilating window to the highest position.
2. Tape retainers in place with filament or duct tape by placing one horizontal strip of tape across each retainer, securing them to the door frame.

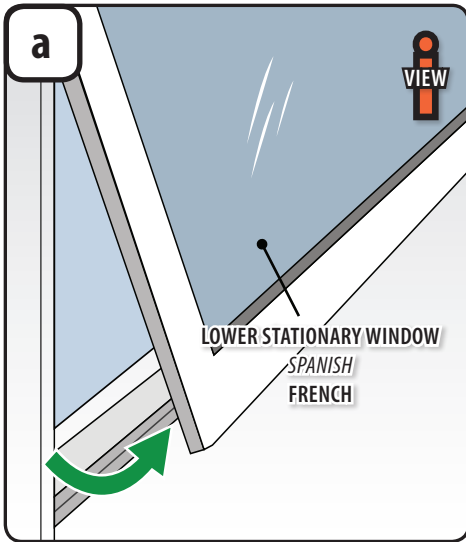

1. Raise the lower stationary window up slightly until it touches the bottom of the screen track retainers.
2. Push the lower portion of the window from the exterior side of the door and lift the window toward you.

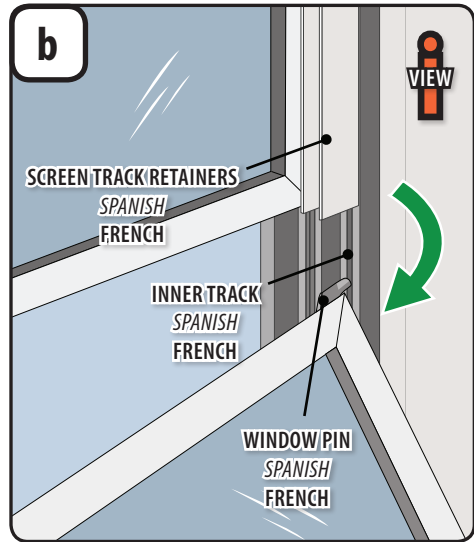

1. Rotate the window clockwise to remove the pin from the inner track.

**3 REINSTALL LOWER STATIONARY WINDOW**

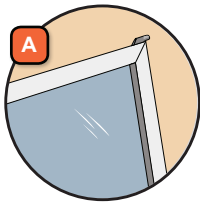
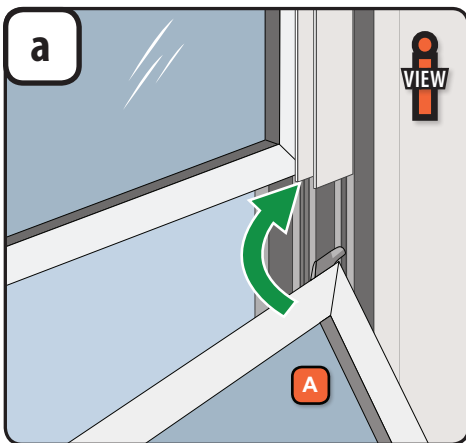
1. Angle lower window and insert top window pins into interior tracks with window latches facing the interior. Raise window until top of window seats into bottom of screen track retainers.

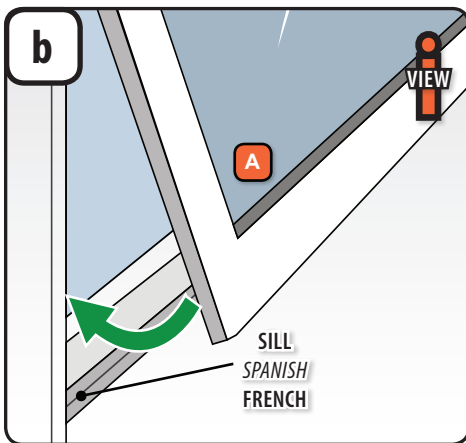

1. Rotate window into place. Press on window top until bottom of window rests on sill.