

Replacement Guide

EMCO®

For Screen Cover Plate on Self-Storing Door with Retractable Insect Screen

IMPORTANT: READ ENTIRE GUIDE BEFORE BEGINNING INSTALLATION.

PLEASE NOTE: Proper assembly, installation and maintenance are essential if the benefits of your EMCO® product are to be fully attained. Therefore, please read and follow this Installation Guide completely. If your abilities do not match this procedure's requirements, contact an experienced contractor.

You may direct any questions to the **Solution Center** at 1-800-933-3626, Monday through Friday, 7 a.m. to 7 p.m. Central Time, and Saturday and Sunday, 8 a.m. to 5 p.m. Central Time.

⚠ WARNING:

Improper use of hand or power tools could result in personal injury and/or product damage. Follow equipment manufacturer's instructions for safe operation. Always wear safety glasses.

⚠ WARNING:

Weight of window and door unit(s) and accessories will vary. Use a reasonable number of people with sufficient strength to lift, carry, and install window and door unit(s) and accessories. Always use appropriate lifting techniques.

REQUIRED TOOLS

- Safety Glasses
- Flathead Screwdriver or 1/4" Socket

1. REMOVE SCREEN COVER PLATE:

- A. Using a flathead screwdriver, remove screws from the screen cover plate.
- B. Once loose, the screen cover plate may be removed by lifting up and towards you. If needed, hold cover plate with one hand while lightly tapping up on end.
- C. Discard and properly dispose of screen cover plate and screws.

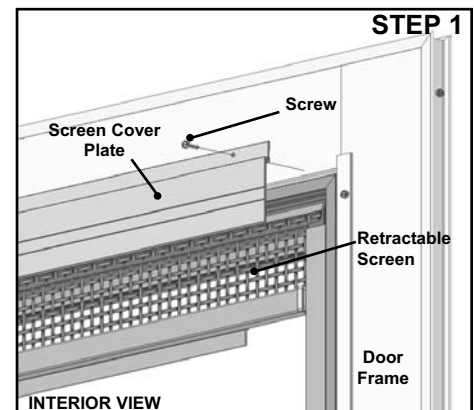

EMCO®**2. REPLACE SCREEN COVER PLATE:**

- A. Install replacement screen cover plate. Make sure that the hook of the screen cover plate hooks over the lip at the top of the window frame.
- B. Align holes and secure the cover plate to door using screws provided.

